

Notice to Current Customers, Neighboring Systems, and Cities

SJWTX, INC. DBA THE TEXAS WATER COMPANY, CERTIFICATE OF CONVENIENCE AND NECESSITY (CCN) NOS. 10692 AND 20877, NOTICE OF INTENT TO PURCHASE WATER AND SEWER FACILITIES AND TO TRANSFER WATER AND SEWER CERTIFICATED SERVICE AREA UNDER CCN NO. 11612 AND 20952 FROM QUADVEST, L.P. IN FORT BEND, HARRIS, LIBERTY, MONTGOMERY, WALKER, AND WALLER COUNTIES, TEXAS

To:

Date Notice Mailed: April 24, 2026

WALLER COUNTY JUDGE
836 AUSTIN ST STE 4300
HEMPSTEAD TX 77445-0428

<u>SJWTX, Inc. dba The Texas Water Company</u>	<u>P.O. Box 1742</u>
(Purchaser's Name)	(Address)
<u>Canyon Lake, TX</u>	<u>78133</u>
(City), (State)	(Zip Code)

has submitted an application with the Public Utility Commission of Texas (Commission) to purchase a portion of the water and sewer facilities and to transfer water and sewer certificated service area under CCN Nos. 11612 and 20952 in Fort Bend, Harris, Liberty, Montgomery, Walker, and Waller counties, TX from:

<u>Quadvest, L.P.</u>	<u>26926 FM 2978</u>
(Seller's Name)	(Address)
<u>Magnolia, TX</u>	<u>77354</u>
(City), (State)	(Zip Code)

The requested area overlaps the district boundaries of: Coastal Water Authority, Harris County FCD, Montgomery County MUD 210, North Harris County Regional Water Authority, Port of Houston Authority, and San Jacinto River Authority. If these districts do not request a public hearing, the Commission shall determine that the district is consenting to SJWTX, Inc. dba the Texas Water Company's request to provide retail water and sewer utility service in the requested area.

The sale is scheduled to take place if approved by the Commission (Texas Water Code § 13.301). The transaction and the transfer of the CCN includes the following: Bauer Landing, Bauer Meadows, Bella Vista, Benders Landing, Benders Landing Estates, Binford Creek, Bridlewood Estates, Brazos Lakes, Camino Real, Campwood, Canterbury Ranch, Clear Creek Forest, Colony at Pinehurst, Creekside Court, Creekside Village, Cypress Trails at Bauer Landing, Decker Farms, Decker Oaks Estates, Decker Prairie, Dewberry Hills, Enclave at Dobbin, Estates of Clear Creek, Firesong, Flagstone, Freeman Ranch, Grand San Jacinto, Hockleywood Business Park, Indigo Lakes Estates, Indigo Skies, Indigo Trails, Jacobs Reserve, Katy Meadows, Lake House, Lake Windcrest, Lakes of Cane Island, Lakes of Fairhaven, Lone Star Ranch, Magnolia Reserve, Magnolia School, Maple Woods, McCall Sound, Mill Creek, Montgomery Trace, Mostyn Manor, Mostyn Springs, Mustang Meadows, Northcrest Ranch, Oakberry Trails, Oakhill Reserve, Olympia Falls, Pine Acre Trails, Rancho San Vicente, Red Oak Ranch, Redbud, Reserve at Katy Hockley, Rockrose Ranch, Rosehill Lakes, Rosehill Meadow, Rosewood, Royal Vista, Sawmill Estates, Sendera Ranch, Sierra Woods, Sonoma Ridge, Stokesbury, Summersett Estates, Sunset Valley, Sweetwater Ridge, Texas Grand Ranch, Trails at Cochran Ranch, Vacek Country Meadows, Vacek Pointe, Victoria Station, Village of Decker Oaks, Westhaven Manor, Wild Rye, Williams Landing, and Windcrest Farms.

Detailed Map #1

Requested Water Areas 1 and 2 in Walker County: Texas Grand Ranch

(Identified with blue hatched areas on maps)

The requested water areas 1 and 2 are located approximately 7.2 miles south of downtown Huntsville, Texas, and is generally bounded on the north by Ball Road; on the east by Lake Raven and East Sandy Creek; on the south by East Sandy Creek; and on the west by Bath Lane.

The requested water areas 1 and 2 include 264 customer connections and approximately 2,010.8 acres to transfer from Quadvest, L.P. (CCN No. 11612) to SJWTX, Inc. dba The Texas Water Company (CCN No. 10692).

Detailed Map #2

Requested Water Area 3 in Montgomery County: Firesong

(Certification Approved in Docket No. 58128 on 4/10/26 after Docket No. 59279 was filed; identified with orange hatched pattern on maps)

The requested water area 3 is located approximately 1.8 miles northeast of downtown Montgomery, Texas, and is generally bounded on the north by Little Lake Creek; on the east by Farm to Market Road 1097; on the south by Farm to Market Road 1097; and on the west by Farm to Market Road 149.

The requested water area 3 includes 0 customer connections and approximately 398 acres to transfer from Quadvest, L.P. (CCN No. 11612) to SJWTX, Inc. dba The Texas Water Company (CCN No. 10692).

Detailed Map #3

Requested Water Area 4 in Montgomery County: Rockrose Ranch

(Identified with blue hatched areas on maps)

The requested water area 4 is located approximately 4.1 miles northwest of downtown Willis, Texas, and is generally bounded on the north by Shepherd Hill Road; on the east by Shepherd Branch; on the south by Calvary Road; and on the west by Squirrel Tree Drive.

The requested water area 4 includes 133 customer connections and approximately 169.7 acres to transfer from Quadvest, L.P. (CCN No. 11612) to SJWTX, Inc. dba The Texas Water Company (CCN No. 10692).

Detailed Map #4

Requested Water Area 5 in Montgomery County: Undeveloped Area

(Identified with blue hatched areas on maps)

The requested water area 5 is located approximately 2.8 miles northeast of downtown Willis, Texas, and is generally bounded on the north by Green Pine Boulevard; on the east by Caney Creek; on the south by Bee Creek Drive; and on the west by Rodgers Road.

The requested water area 5 includes 0 customer connections and approximately 86.4 acres to transfer from Quadvest, L.P. (CCN No. 11612) to SJWTX, Inc. dba The Texas Water Company (CCN No. 10692).

Detailed Map #5

Requested Water Area 6 in Harris County: Westhaven Manor

(Identified with blue hatched areas on maps)

The requested water area 6 is located approximately 4.1 miles north of downtown Waller, Texas, and is generally bounded on the north by Mayer Road; on the east by Fields Store Road; on the south by Knebel Road; and on the west by Farm to Market Road 362.

The requested water area 6 includes 0 customer connections and approximately 195.7 acres to transfer from Quadvest, L.P. (CCN No. 11612) to SJWTX, Inc. dba The Texas Water Company (CCN No. 10692).

Detailed Map #5

Requested Water Areas 7, 8, 9, and 10 in Harris County: Indigo Skies (7), Indigo Trails (8), Wild Rye (9), and Stokesbury (10)

(Identified with blue hatched areas on maps)

The requested water areas 7-10 are located approximately 2.3 miles north of downtown Waller, Texas, and are generally bounded on the north by Spring Creek; on the east by Binford Road; on the south by Waller-Spring Creek Road; and on the west by Farm to Market Road 362.

The requested water areas 7-10 include 170 customer connections and approximately 1,026.2 acres to transfer from Quadvest, L.P. (CCN No. 11612) to SJWTX, Inc. dba The Texas Water Company (CCN No. 10692).

Detailed Map #5

Requested Water Areas 11 and 12 in Harris County: BSR Vining Road

(Pending Certification Approval in Docket No. 58518; identified with orange hatched pattern on maps)

The requested water areas 11 and 12 are located approximately 2.6 miles northeast of downtown Waller, Texas, and are generally bounded on the north by Castle Road; on the east by Binford Road; on the south by Binford Circle; and on the west by Stokes Road.

The requested water areas 11 and 12 include 0 customer connections and approximately 108.2 acres of uncertificated area to amend to Quadvest, L.P. (CCN No. 11612) in Docket No. 58518 (pending approval) and to transfer from Quadvest, L.P. (CCN No. 11612) to SJWTX, Inc. dba The Texas Water Company (CCN No. 10692) in this Docket No. 59279.

Detailed Map #5

Requested Water Areas 13 and 14 in Harris County: Binford Creek (13) and Oakberry Trails (14)

(Identified with blue hatched areas on maps)

The requested water areas 13 and 14 are located approximately 3 miles northeast of downtown Waller, Texas, and are generally bounded on the north by Castle Road; on the east by Kickapoo Road; on the south by Waller-Spring Creek Road; and on the west by Binford Road.

The requested water areas 13 and 14 include 457 customer connections and approximately 427.9 acres to transfer from Quadvest, L.P. (CCN No. 11612) to SJWTX, Inc. dba The Texas Water Company (CCN No. 10692).

Detailed Map #6

Requested Water Areas 15 and 16 in Harris and Waller Counties: Mustang Meadows (15) and Williams Landing (16)

(Identified with blue hatched areas on maps)

The requested water areas 15 and 16 are located approximately 1.8 miles southeast of downtown Waller, Texas, and are generally bounded on the north by Torrey Road; on the east by Mathis Road; on the south by Betka Road; and on the west by Mound Creek.

The requested water areas 15 and 16 include 115 customer connections and approximately 91.7 acres to transfer from Quadvest, L.P. (CCN No. 11612) to SJWTX, Inc. dba The Texas Water Company (CCN No. 10692).

Detailed Map #7

Requested Water Area 17 in Waller County: Trails at Cochran Ranch

(Identified with blue hatched areas on maps)

The requested water area 17 is located approximately 6 miles southwest of downtown Waller, Texas, and is generally bounded on the north by Rodeo Road; on the east by Blinka Road; on the south by Richard Frey Road; and on the west by Cochran Road.

The requested water area 17 includes 0 customer connections and approximately 140.9 acres to transfer from Quadvest, L.P. (CCN No. 11612) to SJWTX, Inc. dba The Texas Water Company (CCN No. 10692).

Detailed Map #8

Requested Water Area 18 in Montgomery and Waller Counties: Maple Woods

(Certification Approved in Docket No. 56719 on 2/4/2026 after Docket No. 59279 was filed; identified with orange hatched pattern on maps)

The requested water area 18 is located approximately 4.8 miles southwest of downtown Magnolia, Texas, and is generally bounded on the north by Hargrave Road; on the east by Montgomery and Waller County Line; on the south by Robin Hood Road; and on the west by Joseph Road.

The requested water area 18 includes 0 customer connections and approximately 142.4 acres to transfer from Quadvest, L.P. (CCN No. 11612) to SJWTX, Inc. dba The Texas Water Company (CCN No. 10692).

Detailed Map # 8

Requested Water Areas 19 and 20 in Montgomery County: Undeveloped Area (19), Indigo Lakes Estates (20), Estates of Clear Creek (20), Clear Creek Forest (20), and Sawmill Estates (20)

(Identified with blue hatched areas on maps)

The requested water areas 19 and 20 are located approximately 0.9 miles southwest of downtown Magnolia, Texas, and are generally bounded on the north by Farm to Market Road 1488; on the east by Mink Branch; on the south by Baneberry Road and Butera Road; and on the west by Montgomery and Waller County Line.

The requested water areas 19 and 20 includes 843 customer connections and approximately 3,506.7 acres to transfer from Quadvest, L.P. (CCN No. 11612) to SJWTX, Inc. dba The Texas Water Company (CCN No. 10692). There is 15.8 acres of pre-existing dual certification between City of Magnolia (CCN No. 11466) and Quadvest, L.P. (CCN No. 11612). After the transfer, 15.8 acres will have dual certification between City of Magnolia (CCN No. 11466) and SJWTX, Inc. dba The Texas Water Company (CCN No. 10692).

Detailed Map #9

Requested Water Area 21 in Montgomery County: Magnolia Reserve

(Identified with blue hatched areas on maps)

The requested water area 21 is located approximately 4.4 miles northeast of downtown Magnolia, Texas, and is generally bounded on the north by Stillwater Boulevard; on the east by Karen Switch Road; on the south by Main Street; and on the west by Farm to Market Road 149.

The requested water area 21 includes 228 customer connections and approximately 169.3 acres to transfer from Quadvest, L.P. (CCN No. 11612) to SJWTX, Inc. dba The Texas Water Company (CCN No. 10692).

Detailed Map #9

Requested Water Area 22 in Montgomery County: Mostyn Manor and Mostyn Springs

(Identified with blue hatched areas on maps)

The requested water area 22 is located approximately 4.7 miles northeast of downtown Magnolia, Texas, and is generally bounded on the north by Lake Creek; on the east by Gable Lane; on the south by Farm to Market Road 1488; and on the west by Farm to Market Road 149.

The requested water area 22 includes 887 customer connections and approximately 630.6 acres to transfer from Quadvest, L.P. (CCN No. 11612) to SJWTX, Inc. dba The Texas Water Company (CCN No. 10692).

Detailed Map #10

Requested Water Areas 23 and 24 in Montgomery County: Magnolia School (23), Canterbury Ranch (24), Lake Windcrest (24), Campwood (24), and Sierra Woods (24)

(Identified with blue hatched areas on maps)

The requested water areas 23 and 24 are located approximately 5.9 miles east of downtown Magnolia, Texas, and are generally bounded on the north by Farm to Market Road 1488; on the east by Cimarron Creek Boulevard; on the south by Mill Creek; and on the west by Huffman Road.

The requested water areas 23 and 24 includes 1,057 customer connections and approximately 2,682.6 acres to transfer from Quadvest, L.P. (CCN No. 11612) to SJWTX, Inc. dba The Texas Water Company (CCN No. 10692).

Detailed Map #11

Requested Water Area 25 in Montgomery County: Montgomery Trace, Windcrest Farms, Sendera Ranch, Red Oak Ranch, and Jacobs Reserve

(Identified with blue hatched areas on maps)

The requested water area 25 is located approximately 5.4 miles southwest of downtown Conroe, Texas, and is generally bounded on the north by Lake Creek; on the east by Ripplewood Circle; on the south by County Road 2643 and Sugar Bush Drive; and on the west by Honea Egypt Road.

The requested water area 25 includes 506 customer connections and approximately 2,313.2 acres to transfer from Quadvest, L.P. (CCN No. 11612) to SJWTX, Inc. dba The Texas Water Company (CCN No. 10692).

Detailed Map #12

Requested Water Area 26 in Montgomery County: Colony at Pinehurst

(Identified with blue hatched areas on maps)

The requested water area 26 is located approximately 1.7 miles northeast of downtown Stagecoach, Texas, and is generally bounded on the north by Farm to Market Road 1774; on the east by Goodson Loop; on the south by Goodson Loop; and on the west by Goodson Loop.

The requested water area 26 includes 192 customer connections and approximately 116.9 acres to transfer from Quadvest, L.P. (CCN No. 11612) to SJWTX, Inc. dba The Texas Water Company (CCN No. 10692). There is 1.9 acres of pre-existing dual certification between Pinehurst Decker Prairie WSC (CCN No. 11768) and Quadvest, L.P. (CCN No. 11612). After the transfer, 1.9 acres will have dual certification between Pinehurst Decker Prairie WSC (CCN No. 11768) and SJWTX, Inc. dba The Texas Water Company (CCN No. 10692).

Detailed Map #12

Requested Water Area 27 in Montgomery County: Decker Oaks Estates and Village of Decker Oaks

(Identified with blue hatched areas on maps)

The requested water area 27 is located approximately 2.3 miles northwest of downtown Tomball, Texas, and is generally bounded on the north by Decker Branch; on the east by Belle Court; on the south by Morris Road; and on the west by State Highway 249.

The requested water area 27 includes 667 customer connections and approximately 84.9 acres to transfer from Quadvest, L.P. (CCN No. 11612) to SJWTX, Inc. dba The Texas Water Company (CCN No. 10692).

Detailed Map #13

Requested Water Areas 28, 29 and 30 in Montgomery County: Mill Creek (28), Enclave at Dobbin (29), and Creekside Court (30)

(Identified with blue hatched areas on maps)

The requested water areas 28-30 are located approximately 3.3 miles north of downtown Tomball, Texas, and is generally bounded on the north by Hardin Store Road; on the east by Farm to Market Road 2978; on the south by Seminole Drive; and on the west by Clint Neidigk Road.

The requested water areas 28-30 include 933 customer connections and approximately 207.8 acres to transfer from Quadvest, L.P. (CCN No. 11612) to SJWTX, Inc. dba The Texas Water Company (CCN No. 10692).

Detailed Map #14

Requested Water Area 31 in Harris and Montgomery Counties: Sonoma Ridge and McCall Sound
(Identified with blue hatched areas on maps)

The requested water area 31 is located approximately 5.2 miles west of downtown Tomball, Texas, and is generally bounded on the north by Walnut Creek; on the east by Decker Prairie Rosehill Road; on the south by Spring Creek; and on the west by Debbie Lane.

The requested water area 31 includes 97 customer connections and approximately 144.3 acres to transfer from Quadvest, L.P. (CCN No. 11612) to SJWTX, Inc. dba The Texas Water Company (CCN No. 10692).

Detailed Map #14

Requested Water Area 32 in Montgomery County: Decker Farms and Rosehill Lakes
(Identified with blue hatched areas on maps)

The requested water area 32 is located approximately 3.3 miles northwest of downtown Tomball, Texas, and is generally bounded on the north by Decker Prairie Rosehill Road; on the east by Holly Lord; on the south by Spring Creek; and on the west by Decker Prairie Rosehill Road and Baker Cemetery Road.

The requested water area 32 includes 552 customer connections and approximately 174.7 acres to transfer from Quadvest, L.P. (CCN No. 11612) to SJWTX, Inc. dba The Texas Water Company (CCN No. 10692).

Detailed Map #14

Requested Water Area 33 in Harris County: Rosehill Meadow
(Identified with blue hatched areas on maps)

The requested water area 33 is located approximately 4.9 miles west of downtown Tomball, Texas, and is generally bounded on the north by Spring Creek; on the east by Country Hill; on the south by Tomball Waller Road; and on the west by Cypress Rosehill Road.

The requested water area 33 includes 244 customer connections and approximately 50.9 acres to transfer from Quadvest, L.P. (CCN No. 11612) to SJWTX, Inc. dba The Texas Water Company (CCN No. 10692).

Detailed Map #14

Requested Water Area 34 in Harris County: Oakhill Reserve
(Identified with blue hatched areas on maps)

The requested water area 34 is located approximately 4.5 miles west of downtown Tomball, Texas, and is generally bounded on the north by Holly Hollow Lane; on the east by Holly Creek Trail; on the south by Farm to Market Road 2920; and on the west by Cypress Rosehill Road.

The requested water area 34 includes 0 customer connections and approximately 99.7 acres to transfer from Quadvest, L.P. (CCN No. 11612) to SJWTX, Inc. dba The Texas Water Company (CCN No. 10692).

Detailed Map #15

Requested Water Area 35 in Harris and Montgomery Counties: Cypress Trails at Bauer Landing, Bauer Landing, and Hockleywood Business Park
(Identified with blue hatched areas on maps)

The requested water area 35 is located approximately 5.1 miles southwest of downtown Stagecoach, Texas, and is generally bounded on the north by Spring Creek; on the east by Roberts Cemetery Road; on the south by Farm to Market Road 2920; and on the west by Murrell Road.

The requested water area 35 includes 1,307 customer connections and approximately 659.4 acres to transfer from Quadvest, L.P. (CCN No. 11612) to SJWTX, Inc. dba The Texas Water Company (CCN No. 10692).

Detailed Map #15

Requested Water Area 36 in Harris County: Bauer Meadows

(Identified with blue hatched areas on maps)

The requested water area 36 is located approximately 6.4 miles southwest of downtown Stagecoach, Texas, and is generally bounded on the north by Farm to Market Road 2920; on the east by Roberts Cemetery Road; on the south by Hopfe Road; and on the west by Bauer Road.

The requested water area 36 includes 177 customer connections and approximately 48.1 acres to transfer from Quadvest, L.P. (CCN No. 11612) to SJWTX, Inc. dba The Texas Water Company (CCN No. 10692).

Detailed Map #16

Requested Water Areas 37, 38, 39, and 40 in Harris County: Sunset Valley (37), Rosewood (38), Redbud (39), and Lakes of Fairhaven (40)

(Identified with blue hatched areas on maps)

The requested water areas 37-40 are located approximately 6.6 miles southwest of downtown Stagecoach, Texas, and are generally bounded on the north by Hopfe Road; on the east by Mueschke Road; on the south by Schiel Road; and on the west by Bauer Road.

The requested water areas 37-40 includes 845 customer connections and approximately 1,401.9 acres to transfer from Quadvest, L.P. (CCN No. 11612) to SJWTX, Inc. dba The Texas Water Company (CCN No. 10692).

Detailed Map #17

Requested Water Area 41 in Montgomery County: Pine Acre Trails

(Identified with blue hatched areas on maps)

The requested water area 41 is located approximately 2.8 miles northwest of downtown Stagecoach, Texas, and is generally bounded on the north by Rustling Oaks drive; on the east by Wren Road; on the south by Northgreen Circle; and on the west by Airport Road.

The requested water area 41 includes 243 customer connections and approximately 257 acres to transfer from Quadvest, L.P. (CCN No. 11612) to SJWTX, Inc. dba The Texas Water Company (CCN No. 10692).

Detailed Map #18

Requested Water Area 42 in Montgomery County: Sweetwater Ridge

(Identified with blue hatched areas on maps)

The requested water area 42 is located approximately 3.9 miles northeast of downtown Cut and Shoot, Texas, and is generally bounded on the north by East Williams Road; on the east by Greenridge Road; on the south by South Williams Road; and on the west by Farm to Market Road 1484.

The requested water area 42 includes 258 customer connections and approximately 312.8 acres to transfer from Quadvest, L.P. (CCN No. 11612) to SJWTX, Inc. dba The Texas Water Company (CCN No. 10692).

Detailed Map #19

Requested Water Area 43 in Montgomery County: Summerset Estates and Lone Star Ranch

(Identified with blue hatched areas on maps)

The requested water area 43 is located approximately 4 miles east of downtown Woodloch, Texas, and is generally bounded on the north by Gulf Coast Road; on the east by Dry Creek; on the south by State Highway 242; and on the west by Farm to Market Road 1314.

The requested water area 43 includes 805 customer connections and approximately 481.3 acres to transfer from Quadvest, L.P. (CCN No. 11612) to SJWTX, Inc. dba The Texas Water Company (CCN No. 10692).

Detailed Map #20

Requested Water Area 44 in Montgomery County: Northcrest Ranch

(Identified with blue hatched areas on maps)

The requested water area 44 is located approximately 0.7 miles west of downtown Woodbranch Village, Texas, and is generally bounded on the north by State Highway 242; on the east by Autumn Lane; on the south by Brook Forest Boulevard; and on the west by Spring Branch.

The requested water area 44 includes 464 customer connections and approximately 1,809.7 acres to transfer from Quadvest, L.P. (CCN No. 11612) to SJWTX, Inc. dba The Texas Water Company (CCN No. 10692).

Detailed Map #21

Requested Water Areas 45 and 46 in Montgomery County: Creekside Village (45), Benders Landing (46), and Benders Landing Estates (46)

(Identified with blue hatched areas on maps)

The requested water areas 45 and 46 are located approximately 4.4 miles southeast of downtown Oak Ridge North, Texas, and are generally bounded on the north by Falls Lake Drive; on the east by West Fork San Jacinto River; on the south by Spring Creek; and on the west by Rayford Road.

The requested water areas 45 and 46 include 2,744 customer connections and approximately 4,271.8 acres to transfer from Quadvest, L.P. (CCN No. 11612) to SJWTX, Inc. dba The Texas Water Company (CCN No. 10692).

Detailed Map #22

Requested Water Area 47 in Harris County: Flagstone

(Identified with blue hatched areas on maps)

The requested water area 47 is located approximately 4.6 miles northwest of downtown Humble, Texas, and is generally bounded on the north by Cypress Creek; on the east by Cypresswood Drive; on the south by Farm to Market Road 1960; and on the west by Broze Road.

The requested water area 47 includes 293 customer connections and approximately 98.1 acres to transfer from Quadvest, L.P. (CCN No. 11612) to SJWTX, Inc. dba The Texas Water Company (CCN No. 10692).

Detailed Map #23

Requested Water Areas 48, 49, and 50 in Liberty County: Bella Vista (48), Villa Nueva (49), and Rancho San Vicente (50)

(Identified with blue hatched areas on maps)

The requested water areas 48-50 are located approximately 1 mile northeast of downtown Plum Grove, Texas, and are generally bounded on the north by County Road 3370A; on the east by Tarkington Bayou; on the south by County Road 3431; and on the west by Farm to Market Road 1010.

The requested water areas 48-50 include 1,311 customer connections and approximately 1,337.3 acres to transfer from Quadvest, L.P. (CCN No. 11612) to SJWTX, Inc. dba The Texas Water Company (CCN No. 10692).

Detailed Map #24

Requested Water Area 51 in Liberty County: Camino Real

(Identified with blue hatched areas on maps)

The requested water area 51 is located approximately 0.7 miles southeast of downtown Plum Grove, Texas, and is generally bounded on the north by Orange Branch; on the east by Long Branch; on the south by County Road 347; and on the west by County Road 347.

The requested water area 51 includes 1,534 customer connections and approximately 1,696 acres to transfer from Quadvest, L.P. (CCN No. 11612) to SJWTX, Inc. dba The Texas Water Company (CCN No. 10692).

Detailed Map #24

Requested Water Area 52 in Liberty and Montgomery Counties: Grand San Jacinto

(Identified with blue hatched areas on maps)

The requested area is located approximately 2.1 miles south of downtown Plum Grove, Texas, and is generally bounded on the north by County Road 347; on the east by Long Branch; on the south by County Road 9026; and on the west by East Fork San Jacinto River.

The requested water area 52 includes 1,779 customer connections and approximately 2,200.9 acres to transfer from Quadvest, L.P. (CCN No. 11612) to SJWTX, Inc. dba The Texas Water Company (CCN No. 10692).

Detailed Map #25

Requested Water Area 53 in Waller County: Dewberry Hills

(Certification Approved in Docket No. 55050 on 2/6/2026 after Docket No. 59279 was filed; identified with orange hatched pattern on maps)

The requested water area 53 is located approximately 4.5 miles northeast of downtown Pattison, Texas, and is generally bounded on the north by Farm to Market Road 529; on the east by Farm to Market Road 2855; on the south by Stockdick Road; and on the west by Farm to Market Road 362.

The requested water area 53 includes 0 customer connections and approximately 212.8 acres to transfer from Quadvest, L.P. (CCN No. 11612) to SJWTX, Inc. dba The Texas Water Company (CCN No. 10692).

Detailed Map #25

Requested Water Area 54 in Waller County: Freeman Ranch

(Identified with blue hatched areas on maps)

The requested water area 54 is located approximately 5.7 miles northwest of downtown Katy, Texas, and is generally bounded on the north by Farm to Market Road 529; on the east by Harris and Waller County Line; on the south by Beckendorf Road; and on the west by Farm to Market Road 2855.

The requested water area 54 includes 789 customer connections and approximately 280.9 acres to transfer from Quadvest, L.P. (CCN No. 11612) to SJWTX, Inc. dba The Texas Water Company (CCN No. 10692).

Detailed Map #25

Requested Water Area 55 in Waller and Harris Counties: Lake House

(Identified with blue hatched areas on maps)

The requested water area 55 is located approximately 3.2 miles north of downtown Katy, Texas, and is generally bounded on the north by Cane Island Branch; on the east by Pitts Road; on the south by Clay Road; and on the west by Schlipf Road.

The requested water area 55 includes 357 customer connections and approximately 224.4 acres to transfer from Quadvest, L.P. (CCN No. 11612) to SJWTX, Inc. dba The Texas Water Company (CCN No. 10692).

Detailed Map #25

Requested Water Area 56 in Waller County: Lakes of Cane Island

(Certification Approved in Docket No. 58063 on 3/13/2026 after Docket No. 59279 was filed; identified with orange hatched pattern on maps)

The requested water area 56 is located approximately 2.7 miles northwest of downtown Katy, Texas, and is generally bounded on the north by Clay Road; on the east by Pitts Road; on the south by Morton Road; and on the west by Schlipf Road.

The requested water area 56 includes 0 customer connections and approximately 220.9 acres to transfer from Quadvest, L.P. (CCN No. 11612) to SJWTX, Inc. dba The Texas Water Company (CCN No. 10692).

Detailed Map #25

Requested Water Area 57 in Harris County: Reserve at Katy Hockley and Katy Meadows

(Identified with blue hatched areas on maps)

The requested water area 57 is located approximately 3.4 miles north of downtown Katy, Texas, and is generally bounded on the north by Stockdick School Road; on the east by Katy Hockley Road; on the south by Clay Road; and on the west by Shadow Grass Drive.

The requested water area 57 includes 11 customer connections and approximately 189.6 acres to transfer from Quadvest, L.P. (CCN No. 11612) to SJWTX, Inc. dba The Texas Water Company (CCN No. 10692).

Detailed Map #26

Requested Water Areas 58 and 59 in Fort Bend County: Vacek Pointe (58) and Vacek Country Meadows (59)

(Identified with blue hatched areas on maps)

The requested water areas 58 and 59 are located approximately 0.8 miles east of downtown Fairchilds, Texas, and are generally bounded on the north by Fairchilds Creek; on the east by Boothline Road; on the south by Farm to Market Road 361; and on the west by Fairchilds Road.

The requested water areas 58 and 59 include 487 customer connections and approximately 154.4 acres to transfer from Quadvest, L.P. (CCN No. 11612) to SJWTX, Inc. dba The Texas Water Company (CCN No. 10692).

Detailed Map #27

Requested Water Area 60 in Fort Bend County: Bridlewood Estates

(Identified with blue hatched areas on maps)

The requested water area 60 is located approximately 6.1 miles southeast of downtown Rosenberg, Texas, and is generally bounded on the north by Farm to Market Road 2759; on the east by State Highway 99; on the south by A Myers Road; and on the west by Blossom Terrace Lane.

The requested water area 60 includes 439 customer connections and approximately 760 acres to transfer from Quadvest, L.P. (CCN No. 11612) to SJWTX, Inc. dba The Texas Water Company (CCN No. 10692).

Detailed Map #28

Requested Water Area 61 in Fort Bend County: Brazos Lakes

(Identified with blue hatched areas on maps)

The requested water area 61 is located approximately 4.7 miles southwest of downtown Thompsons, Texas, and is generally bounded on the north by Smithers Lake Road; on the east by Rabbs Prairie Road; on the south by Worthington Lake; and on the west by Farm to Market Road 762.

The requested water area 61 includes 170 customer connections and approximately 478 acres to transfer from Quadvest, L.P. (CCN No. 11612) to SJWTX, Inc. dba The Texas Water Company (CCN No. 10692).

Detailed Map #29

Requested Water Area 62 in Fort Bend County: Olympia Falls

(Identified with blue hatched areas on maps)

The requested water area 62 is located approximately 4.7 miles southeast of downtown Missouri City, Texas, and is generally bounded on the north by Mustang Bayou; on the east by Long Point Creek; on the south by Senior Road; and on the west by Fort Bend Parkway.

The requested water area 62 includes 322 customer connections and approximately 131.5 acres to transfer from Quadvest, L.P. (CCN No. 11612) to SJWTX, Inc. dba The Texas Water Company (CCN No. 10692).

Total Requested Water Areas 1-62:

The total requested water areas (1-62) include 21,680 customer connections and approximately 32,206.3 acres to transfer from Quadvest, L.P. (CCN No. 11612) to SJWTX, Inc. dba The Texas Water Company (CCN No. 10692). The application proposes the subtraction of approximately 32,206.3 acres from CCN No. 11612 and the addition of approximately 32,206.3 acres to CCN No. 20962.

Detailed Map #1

Requested Sewer Area 1 in Montgomery County: Firesong

(Certification Approved in Docket No. 58128 on 4/10/26 after Docket No. 59279 was filed; identified with orange hatched pattern on maps)

The requested sewer area 1 is located approximately 1.7 miles northeast of downtown Montgomery, Texas, and is generally bounded on the north by Little Lake Creek and Big Oak Drive; on the east by Farm to Market Road 1097 and Lake Conroe; on the south by Farm to Market Road 1097; and on the west by Farm to Market Road 149 and.

The requested sewer area 1 includes 0 customer connections and approximately 398 acres to transfer from Quadvest, L.P. (CCN No. 20952) to SJWTX, Inc. dba The Texas Water Company (CCN No. 20877).

Detailed Map #2

Requested Sewer Area 2 in Montgomery County: Rockrose Ranch

(Identified with purple hatched areas on maps)

The requested sewer area 2 is located approximately 4.1 miles northwest of downtown Willis, Texas, and is generally bounded on the north by Shepherd Hill Road; on the east by Shephard Branch; on the south by Calvary Road; and on the west by Squirrel Tree Drive.

The requested sewer area 2 includes 130 customer connections and approximately 169.7 acres to transfer from Quadvest, L.P. (CCN No. 20952) to SJWTX, Inc. dba The Texas Water Company (CCN No. 20877).

Detailed Map #3

Requested Sewer Areas 3, 4, and 5 in Harris County: Indigo Skies (3), Indigo Trails (4), and Wild Rye (5)

(Identified with purple hatched areas on maps)

The requested sewer areas 3-5 are located approximately 2.3 miles north of downtown Waller, Texas, and are generally bounded on the north by Castle Road; on the east by Binford Road; on the south by Waller-Spring Creek Road; and on the west by Farm to Market Road 362.

The requested sewer areas 3-5 include 73 customer connections and approximately 923.9 acres to transfer from Quadvest, L.P. (CCN No. 20952) to SJWTX, Inc. dba The Texas Water Company (CCN No. 20877).

Detailed Map #3

Requested Sewer Area 6 in Harris County: Stokesbury

(Pending Certification Approval in Docket No. 57704; identified with orange hatched pattern on maps)

The requested sewer area 6 is located approximately 3.9 miles northeast of downtown Waller, Texas, and is generally bounded on the north by Spring Creek; on the east by Binford Road; on the south by Castle Road; and on the west by 1 mile east of Fields Store Road.

The requested sewer area 6 includes 0 customer connections and approximately 102.2 acres of uncertificated area to amend to Quadvest, L.P. (CCN No. 20952) in Docket No. 57704 (pending approval) and to transfer from Quadvest, L.P. (CCN No. 20952) to SJWTX, Inc. dba The Texas Water Company (CCN No. 20877) in this Docket No. 59279.

Detailed Map #3

Requested Sewer Areas 7 and 8 in Harris County: BSR Vining Road

(Pending Certification Approval in Docket No. 58518; identified with orange hatched pattern on maps)

The requested sewer areas 7 and 8 are located approximately 2.6 miles northeast of downtown Waller, Texas, and are generally bounded on the north by Castle Road; on the east by Binford Road; on the south by Binford Circle; and on the west by Stokes Road.

The requested sewer areas 7 and 8 include 0 customer connections and approximately 108.2 acres of uncertificated area to amend to Quadvest, L.P. (CCN No. 20952) in Docket No. 58518 (pending approval) and to transfer from Quadvest, L.P. (CCN No. 20952) to SJWTX, Inc. dba The Texas Water Company (CCN No. 20877) in this Docket No. 59279.

Detailed Map #3

Requested Sewer Areas 9 and 10 in Harris County: Binford Creek (9) and Oakberry Trails (10)

(Identified with purple hatched areas on maps)

The requested sewer areas 9 and 10 are located approximately 3 miles northeast of downtown Waller, Texas, and are generally bounded on the north by Castle Road; on the east by Kickapoo Road; on the south by Waller-Spring Creek Road; and on the west by Binford Road.

The requested sewer areas 9 and 10 include 442 customer connections and approximately 427.9 acres to transfer from Quadvest, L.P. (CCN No. 20952) to SJWTX, Inc. dba The Texas Water Company (CCN No. 20877).

Detailed Map #4

Requested Sewer Areas 11 and 12 in Harris and Waller Counties: Mustang Meadows (11) and Williams Landing (12)

(Identified with purple hatched areas on maps)

The requested sewer areas 11 and 12 are located approximately 1.8 miles southeast of downtown Waller, Texas, and is generally bounded on the north by Torrey Road; on the east by Mathis Road; on the south by Betka Road; and on the west by Mound Creek.

The requested sewer areas 11 and 12 include 111 customer connections and approximately 91.7 acres to transfer from Quadvest, L.P. (CCN No. 20952) to SJWTX, Inc. dba The Texas Water Company (CCN No. 20877).

Detailed Map #5

Requested Sewer Area 13 in Waller County: Trails at Cochran Ranch

(Pending Certification Approval in Docket No. 56192; identified with orange hatched pattern on maps)

The requested sewer area 13 is located approximately 6 miles southwest of downtown Waller, Texas, and is generally bounded on the north by Rodeo Road; on the east by Blinka Road; on the south by Richard Frey Road; and on the west by Cochran Road.

The requested sewer area 13 includes 0 customer connections and approximately 89.8 acres of uncertificated area to amend to Quadvest, L.P. (CCN No. 20952) in Docket No. 56192 (pending approval) and to transfer from Quadvest, L.P. (CCN No. 20952) to SJWTX, Inc. dba The Texas Water Company (CCN No. 20877) in this Docket No. 59279.

Detailed Map #6

Requested Sewer Area 14 in Montgomery and Waller Counties: Maple Woods

(Certification Approved in Docket No. 56719 on 2/4/2026 after Docket No. 59279 was filed; identified with orange hatched pattern on maps)

The requested sewer area 14 is located approximately 4.7 miles southwest of downtown Magnolia, Texas, and is generally bounded on the north by Hargrave Road; on the east by Montgomery and Waller County Line; on the south by Robin Hood Road; and on the west by Joseph Road.

The requested sewer area 14 includes 0 customer connections and approximately 142.4 acres to transfer from Quadvest, L.P. (CCN No. 20952) to SJWTX, Inc. dba The Texas Water Company (CCN No. 20877).

Detailed Map #7

Requested Sewer Area 15 in Montgomery County: Magnolia Reserve

(Identified with purple hatched areas on maps)

The requested sewer area 15 is located approximately 4.4 miles northeast of downtown Magnolia, Texas, and is generally bounded on the north by Stillwater Boulevard; on the east by Karen Switch Road; on the south by Main Street; and on the west by Farm to Market Road 149.

The requested sewer area 15 includes 226 customer connections and approximately 169.3 acres to transfer from Quadvest, L.P. (CCN No. 20952) to SJWTX, Inc. dba The Texas Water Company (CCN No. 20877).

Detailed Map #7

Requested Sewer Area 16 in Montgomery County: Mostyn Manor and Mostyn Springs

(Identified with purple hatched areas on maps)

The requested sewer area 16 is located approximately 4.7 miles northeast of downtown Magnolia, Texas, and is generally bounded on the north by Lake Creek; on the east by Gable Lane; on the south by Farm to Market Road 1488; and on the west by Farm to Market Road 149.

The requested sewer area 16 includes 760 customer connections and approximately 484.3 acres to transfer from Quadvest, L.P. (CCN No. 20952) to SJWTX, Inc. dba The Texas Water Company (CCN No. 20877).

Detailed Map #7

Requested Sewer Area 17 in Montgomery County: Magnolia School

(Identified with purple hatched areas on maps)

The requested sewer area 17 is located approximately 6.2 miles east of downtown Magnolia, Texas, and is generally bounded on the north by Farm to Market Road 1488; on the east by Karen Street; on the south by Edgewater Drive; and on the west by Dry Creek.

The requested sewer area 17 includes 1 customer connection and approximately 50.2 acres to transfer from Quadvest, L.P. (CCN No. 20952) to SJWTX, Inc. dba The Texas Water Company (CCN No. 20877).

Detailed Map #8

Requested Sewer Area 18 in Montgomery County: Colony at Pinchurst

(Identified with purple hatched areas on maps)

The requested sewer area 18 is located approximately 1.7 miles northeast of downtown Stagecoach, Texas, and is generally bounded on the north by Farm to Market Road 1774; on the east by Goodson Loop; on the south by Goodson Loop; and on the west by Goodson Loop.

The requested sewer area 18 includes 177 customer connections and approximately 126.1 acres to transfer from Quadvest, L.P. (CCN No. 20952) to SJWTX, Inc. dba The Texas Water Company (CCN No. 20877).

Detailed Map #9

Requested Sewer Area 19 in Montgomery County: Decker Oaks Estates, Victoria Station, and Village of Decker Oaks

(Identified with purple hatched areas on maps)

The requested sewer area 19 is located approximately 3.3 miles northwest of downtown Tomball, Texas, and is generally bounded on the north by Decker Branch; on the east by Belle Court; on the south by Morris Road; and on the west by State Hwy 249.

The requested sewer area 19 includes 646 customer connections and approximately 87 acres to transfer from Quadvest, L.P. (CCN No. 20952) to SJWTX, Inc. dba The Texas Water Company (CCN No. 20877).

Detailed Map #9

Requested Sewer Area 20 in Harris and Montgomery Counties: Decker Prairie

(Identified with purple hatched areas on maps)

The requested sewer area 20 is located approximately 2.2 miles northwest of downtown Tomball, Texas, and is generally bounded on the north by State Highway 249; on the east by Vallie Road; on the south by Spring Creek; and on the west by County Road 2973.

The requested sewer area 20 includes 54 customer connections and approximately 1,444.3 acres to transfer from Quadvest, L.P. (CCN No. 20952) to SJWTX, Inc. dba The Texas Water Company (CCN No. 20877).

Detailed Map #9

Requested Sewer Area 21 in Montgomery County: Decker Farms and Rosehill Lakes

(Identified with purple hatched areas on maps)

The requested sewer area 21 is located approximately 3.3 miles northwest of downtown Tomball, Texas, and is generally bounded on the north by County Road 2973; on the east by Holly Lord; on the south by Spring Creek; and on the west by County Road 2973.

The requested sewer area 21 includes 545 customer connections and approximately 174.7 acres to transfer from Quadvest, L.P. (CCN No. 20952) to SJWTX, Inc. dba The Texas Water Company (CCN No. 20877).

Detailed Map #10

Requested Sewer Areas 22, 23, and 24 in Montgomery County: Mill Creek (22), Enclave at Dobbin (23), and Creekside Court (24)

(Identified with purple hatched areas on maps)

The requested sewer areas 22-24 are located approximately 3.3 miles north of downtown Tomball, Texas, and are generally bounded on the north by Hardin Store Road; on the east by Farm to Market Road 2978; on the south by Seminole Drive; and on the west by Clint Neidigk Road.

The requested sewer areas 22-24 include 919 customer connections and approximately 207.8 acres to transfer from Quadvest, L.P. (CCN No. 20952) to SJWTX, Inc. dba The Texas Water Company (CCN No. 20877).

Detailed Map #11

Requested Sewer Area 25 in Harris County: Rosehill Meadow

(Identified with purple hatched areas on maps)

The requested sewer area 25 is located approximately 3.1 miles south of downtown Stagecoach, Texas, and is generally bounded on the north by Spring Creek; on the east by Country Hills; on the south by Farm to Market Road 2920; and on the west by Cypress Rosehill Road.

The requested sewer area 25 includes 236 customer connections and approximately 50.9 acres to transfer from Quadvest, L.P. (CCN No. 20952) to SJWTX, Inc. dba The Texas Water Company (CCN No. 20877).

Detailed Map #11

Requested Sewer Area 26 in Harris County: Oakhill Reserve

(Identified with purple hatched areas on maps)

The requested sewer area 26 is located approximately 3.4 miles south of downtown Tomball, Texas, and is generally bounded on the north by Holly Hollow Lane; on the east by Holly Creek Trail; on the south by Farm to Market Road 2920; and on the west by Cypress Rosehill Road.

The requested sewer area 26 includes 0 customer connections and approximately 99.7 acres to transfer from Quadvest, L.P. (CCN No. 20952) to SJWTX, Inc. dba The Texas Water Company (CCN No. 20877).

Detailed Map #12

Requested Sewer Area 27 in Harris and Montgomery Counties: Cypress Trails at Bauer Landing, Bauer Landing, and Hockleywood Business Park

(Identified with purple hatched areas on maps)

The requested sewer area 27 is located approximately 5.1 miles southwest of downtown Stagecoach, Texas, and is generally bounded on the north by Spring Creek; on the east by Roberts Cemetery Road; on the south by Farm to Market Road 2920; and on the west by Murrell Road.

The requested sewer area 27 includes 1,251 customer connections and approximately 659.4 acres to transfer from Quadvest, L.P. (CCN No. 20952) to SJWTX, Inc. dba The Texas Water Company (CCN No. 20877).

Detailed Map #12

Requested Sewer Area 28 in Harris County: Bauer Meadows

(Identified with purple hatched areas on maps)

The requested sewer area 28 is located approximately 6.4 miles southwest of downtown Stagecoach, Texas, and is generally bounded on the north by Farm to Market Road 2920; on the east by Roberts Cemetery Road; on the south by Hopfe Road; and on the west by Bauer Road.

The requested sewer area 28 includes 174 customer connections and approximately 48.1 acres to transfer from Quadvest, L.P. (CCN No. 20952) to SJWTX, Inc. dba The Texas Water Company (CCN No. 20877).

Detailed Map #13

Requested Sewer Areas 29, 30, 31, and 32 in Harris County: Sunset Valley (29), Rosewood (30), Redbud (31), and Lakes of Fairhaven (32)

(Identified with purple hatched areas on maps)

The requested sewer areas 29-32 are located approximately 6.6 miles southwest of downtown Stagecoach, Texas, and are generally bounded on the north by Hopfe Road; on the east by Mueschke Road; on the south by Schiel Road; and on the west by Bauer Road.

The requested sewer areas 29-32 include 817 customer connections and approximately 1,401.9 acres to transfer from Quadvest, L.P. (CCN No. 20952) to SJWTX, Inc. dba The Texas Water Company (CCN No. 20877).

Detailed Map #14

Requested Sewer Area 33 in Montgomery County: Pine Acre Trails

(Identified with purple hatched areas on maps)

The requested sewer area 33 is located approximately 2.8 miles northwest of downtown Cut and Shoot, Texas, and is generally bounded on the north by Rustling Oaks drive; on the east by Wren Road; on the south by Northgreen Circle; and on the west by Airport Road.

The requested sewer area 33 includes 242 customer connections and approximately 257 acres to transfer from Quadvest, L.P. (CCN No. 20952) to SJWTX, Inc. dba The Texas Water Company (CCN No. 20877).

Detailed Map #15

Requested Sewer Area 34 in Montgomery County: Sweetwater Ridge

(Identified with purple hatched areas on maps)

The requested sewer area 34 is located approximately 3.9 miles northeast of downtown Cut and Shoot, Texas, and is generally bounded on the north by East Williams Road; on the east by Greenridge Road; on the south by South Williams Road; and on the west by Farm to Market Road 1484.

The requested sewer area 34 includes 251 customer connections and approximately 312.8 acres to transfer from Quadvest, L.P. (CCN No. 20952) to SJWTX, Inc. dba The Texas Water Company (CCN No. 20877).

Detailed Map #16

Requested Sewer Area 35 in Montgomery County: Summerset Estates and Lone Star Ranch

(Identified with purple hatched areas on maps)

The requested sewer area 35 is located approximately 4 miles east of downtown Woodloch, Texas, and is generally bounded on the north by Gulf Coast Road; on the east by Lone Star Ranch Road; on the south by State Highway 242; and on the west by Farm to Market Road 1314.

The requested sewer area 35 includes 753 customer connections and approximately 331.3 acres to transfer from Quadvest, L.P. (CCN No. 20952) to SJWTX, Inc. dba The Texas Water Company (CCN No. 20877).

Detailed Map #17

Requested Sewer Area 36 in Montgomery County: Creekside Village

(Identified with purple hatched areas on maps)

The requested sewer area 36 is located approximately 4.4 miles southeast of downtown Oak Ridge North, Texas, and is generally bounded on the north by Falls Lake Drive; on the east by Red River Loop; on the south by State Highway 99; and on the west by Wrights Landing.

The requested sewer area 36 includes 749 customer connections and approximately 217.6 acres to transfer from Quadvest, L.P. (CCN No. 20952) to SJWTX, Inc. dba The Texas Water Company (CCN No. 20877).

Detailed Map #17

Requested Sewer Area 37 in Montgomery County: Benders Landing Estates

(Identified with purple hatched areas on maps)

The requested sewer area 37 is located approximately 7.3 miles southeast of downtown Oak Ridge North, Texas, and is generally bounded on the north by West Fork San Jacinto River; on the east by 0 West Fork San Jacinto River; on the south by Whispering Maple Way; and on the west by East Benders Landing Blvd.

The requested sewer area 37 includes 236 customer connections and approximately 278.9 acres to transfer from Quadvest, L.P. (CCN No. 20952) to SJWTX, Inc. dba The Texas Water Company (CCN No. 20877).

Detailed Map #18

Requested Sewer Area 38 in Harris County: Flagstone

(Identified with purple hatched areas on maps)

The requested sewer area 38 is located approximately 4.6 miles northwest of downtown Humble, Texas, and is generally bounded on the north by Cypress Creek; on the east by Cypresswood Drive; on the south by Farm to Market Road 1960; and on the west by Broze Road.

The requested sewer area 38 includes 289 customer connections and approximately 98.1 acres to transfer from Quadvest, L.P. (CCN No. 20952) to SJWTX, Inc. dba The Texas Water Company (CCN No. 20877).

Detailed Map #19

Requested Sewer Areas 39, 40, and 41 in Liberty County: Royal Vista (39), Bella Vista (39), Villa Nueva (40), and Rancho San Vicente (41)

(Identified with purple hatched areas on maps)

The requested sewer areas 39-41 are located approximately 1 mile north of downtown Plum Grove, Texas, and are generally bounded on the north by County Road 3370A; on the east by Tarkington Bayou; on the south by County Road 3431; and on the west by Farm to Market Road 1010.

The requested sewer areas 39-41 include 1,307 customer connections and approximately 1,380.6 acres to transfer from Quadvest, L.P. (CCN No. 20952) to SJWTX, Inc. dba The Texas Water Company (CCN No. 20877).

Detailed Map #20

Requested Sewer Area 42 in Liberty County: Camino Real

(Identified with purple hatched areas on maps)

The requested sewer area 42 is located approximately 0.7 miles southeast of downtown Plum Grove, Texas, and is generally bounded on the north by Orange Branch; on the east by Long Branch; on the south by County Road 352; and on the west by County Road 347.

The requested sewer area 42 includes 1,533 customer connections and approximately 1,696 acres to transfer from Quadvest, L.P. (CCN No. 20952) to SJWTX, Inc. dba The Texas Water Company (CCN No. 20877).

Detailed Map #20

Requested Sewer Area 43 in Liberty and Montgomery Counties: Grand San Jacinto

(Identified with purple hatched areas on maps)

The requested sewer area 43 is located approximately 2.1 miles south of downtown Plum Grove, Texas, and is generally bounded on the north by County Road 3475; on the east by Long Branch; on the south by County Road 9026; and on the west by East Fork San Jacinto River.

The requested sewer area 43 includes 1,778 customer connections and approximately 2,200.9 acres to transfer from Quadvest, L.P. (CCN No. 20952) to SJWTX, Inc. dba The Texas Water Company (CCN No. 20877).

Detailed Map #21

Requested Sewer Area 44 in Waller County: Dewberry Hills

(Certification Approved in Docket No. 55050 on 2/6/2026 after Docket No. 59279 was filed; identified with orange hatched pattern on maps)

The requested sewer area 44 is located approximately 4.5 miles northeast of downtown Pattison, Texas, and is generally bounded on the north by Farm to Market Road 529; on the east by Farm to Market Road 2855; on the south by Stockdick Road; and on the west by Farm to Market Road 362.

The requested sewer area 44 includes 0 customer connections and approximately 212.8 acres to transfer from Quadvest, L.P. (CCN No. 20952) to SJWTX, Inc. dba The Texas Water Company (CCN No. 20877).

Detailed Map #21

Requested Sewer Area 45 in Waller County: Freeman Ranch

(Identified with purple hatched areas on maps)

The requested sewer area 45 is located approximately 5.7 miles northwest of downtown Katy, Texas, and is generally bounded on the north by Farm to Market Road 529; on the east by Harris and Waller County Line; on the south by Beckendorf Road; and on the west by Farm to Market Road 2855.

The requested sewer area 45 includes 781 customer connections and approximately 280.9 acres to transfer from Quadvest, L.P. (CCN No. 20952) to SJWTX, Inc. dba The Texas Water Company (CCN No. 20877).

Detailed Map #21

Requested Sewer Area 46 in Waller and Harris Counties: Lake House

(Identified with purple hatched areas on maps)

The requested sewer area 46 is located approximately 3.2 miles northwest of downtown Katy, Texas, and is generally bounded on the north by Cane Island Branch; on the east by Pitts Road; on the south by Clay Road; and on the west by Schliph Road.

The requested sewer area 46 includes 352 customer connections and approximately 224.4 acres to transfer from Quadvest, L.P. (CCN No. 20952) to SJWTX, Inc. dba The Texas Water Company (CCN No. 20877).

Detailed Map #21

Requested Sewer Area 47 in Waller County: Lakes of Cane Island

(Certification Approved in Docket No. 58063 on 3/13/2026 after Docket No. 59279 was filed; identified with orange hatched pattern on maps)

The requested sewer area 47 is located approximately 2.4 miles northwest of downtown Katy, Texas, and is generally bounded on the north by Clay Road; on the east by Pitts Road; on the south by Morton Road; and on the west by Schliph Road.

The requested sewer area 47 includes 0 customer connections and approximately 220.9 acres to transfer from Quadvest, L.P. (CCN No. 20952) to SJWTX, Inc. dba The Texas Water Company (CCN No. 20877).

Detailed Map #21

Requested Sewer Area 48 in Harris County: Reserve at Katy Hockley and Katy Meadows

(Identified with purple hatched areas on maps)

The requested sewer area 48 is located approximately 3.4 miles north of downtown Katy, Texas, and is generally bounded on the north by Stockdick School Road; on the east by Katy Hockley Road; on the south by Clay Road; and on the west by Shadow Grass Drive.

The requested sewer area 48 includes 10 customer connections and approximately 189.7 acres to transfer from Quadvest, L.P. (CCN No. 20952) to SJWTX, Inc. dba The Texas Water Company (CCN No. 20877).

Detailed Map #22

Requested Sewer Areas 49 and 50 in Fort Bend County: Vacek Pointe (49) and Vacek Country Meadows (50)

(Identified with purple hatched areas on maps)

The requested sewer areas 49 and 50 are located approximately 0.8 miles east of downtown Fairchilds, Texas, and are generally bounded on the north by Fairchilds Creek; on the east by Boothline Road; on the south by Farm to Market Road 361; and on the west by Fairchilds Road.

The requested sewer areas 49 and 50 include 484 customer connections and approximately 154.4 acres to transfer from Quadvest, L.P. (CCN No. 20952) to SJWTX, Inc. dba The Texas Water Company (CCN No. 20877).

Detailed Map #23

Requested Sewer Area 51 in Fort Bend County: Olympia Falls

(Identified with purple hatched areas on maps)

The requested sewer area 51 is located approximately 4.1 miles southeast of downtown Rosenberg, Texas, and is generally bounded on the north by Mustang Bayou; on the east by Long Point Creek; on the south by Senior Road; and on the west by Fort Bend Parkway.

The requested sewer area 51 includes 318 customer connections and approximately 131.5 acres to transfer from Quadvest, L.P. (CCN No. 20952) to SJWTX, Inc. dba The Texas Water Company (CCN No. 20877).

Total Requested Sewer Areas 1-51:

The total requested sewer areas (1-51) include 15,645 customer connections and approximately 15,645.3 acres to transfer from Quadvest, L.P. (CCN No. 20952) to SJWTX, Inc. dba The Texas Water Company (CCN No. 20877). The application proposes the subtraction of approximately 15,645.3 acres from CCN No. 20952 and the addition of approximately 15,645.3 acres to CCN No. 20877.

See enclosed maps of the requested areas. All proposed maps may be viewed at: <https://www.txwaterco.com/our-company/quadvest-acquisition-notice-puc-docket-no-59279>

This transaction will not have an effect on the current customer's rates and services.

Persons who wish to intervene in the proceeding or comment upon action sought should contact the Public Utility Commission, P.O. Box 13326, Austin, Texas 78711-3326, or call the Public Utility Commission at (512) 936-7120 or (888) 782-8477. Hearing- and speech-impaired individuals may contact the commission through Relay Texas at 1-800-735-2989. The deadline for intervention in the proceeding is (30 days from the mailing or publication of notice, whichever occurs later, unless otherwise provided by the presiding officer). You must send a letter requesting intervention to the commission which is received by that date.*

The letter must include the person's name, address, email address, and fax number, if applicable.

**Hearing- and speech-impaired individuals with text telephones (TTY) may alternatively contact the commission directly at (512) 936-7136.*

If a valid public hearing is requested, the Commission will refer the application to the State Office of Administrative Hearings (SOAH) for a hearing. If no settlement is reached and an evidentiary hearing is held, SOAH will submit a recommendation to the Commission for a final decision. An evidentiary hearing is a legal proceeding similar to a civil trial in state district court.

A landowner with a tract of land at least 25 acres or more, that is partially or wholly located within the requested area, may file a written request with the Commission to be excluded from the requested area ("opt-out") within 30 days from the date that notice was provided by the Utility. All landowner opt-out requests must include the commission docket number, CCN number, the total acreage to remove from the requested area, a sealed or embossed metes and bounds description or survey of the landowner's tract of land, and the landowner's name, address, email address and fax number, if applicable.

A landowner that opts out from the requested area releases the applicant's obligation to provide retail water and sewer utility service to the removed land for any reason.

Persons who wish to request this option should file the required documents with the:

Public Utility Commission of Texas
Central Records

1701 N. Congress, P. O. Box 13326
Austin, TX 78711-3326

In addition, the landowner must also send a copy of the opt out request to the Utility. Staff may request additional information regarding your request.

Si desea información en español, puede llamar al 1-888-782-8477.

Aundrea Williams, President
SJWTX, Inc., dba The Texas Water Company

Transfer Quadvest, L.P. (CCN No. 11612) to SJWTX, Inc. dba The Texas Water Company (CCN No. 10692) in Walker County

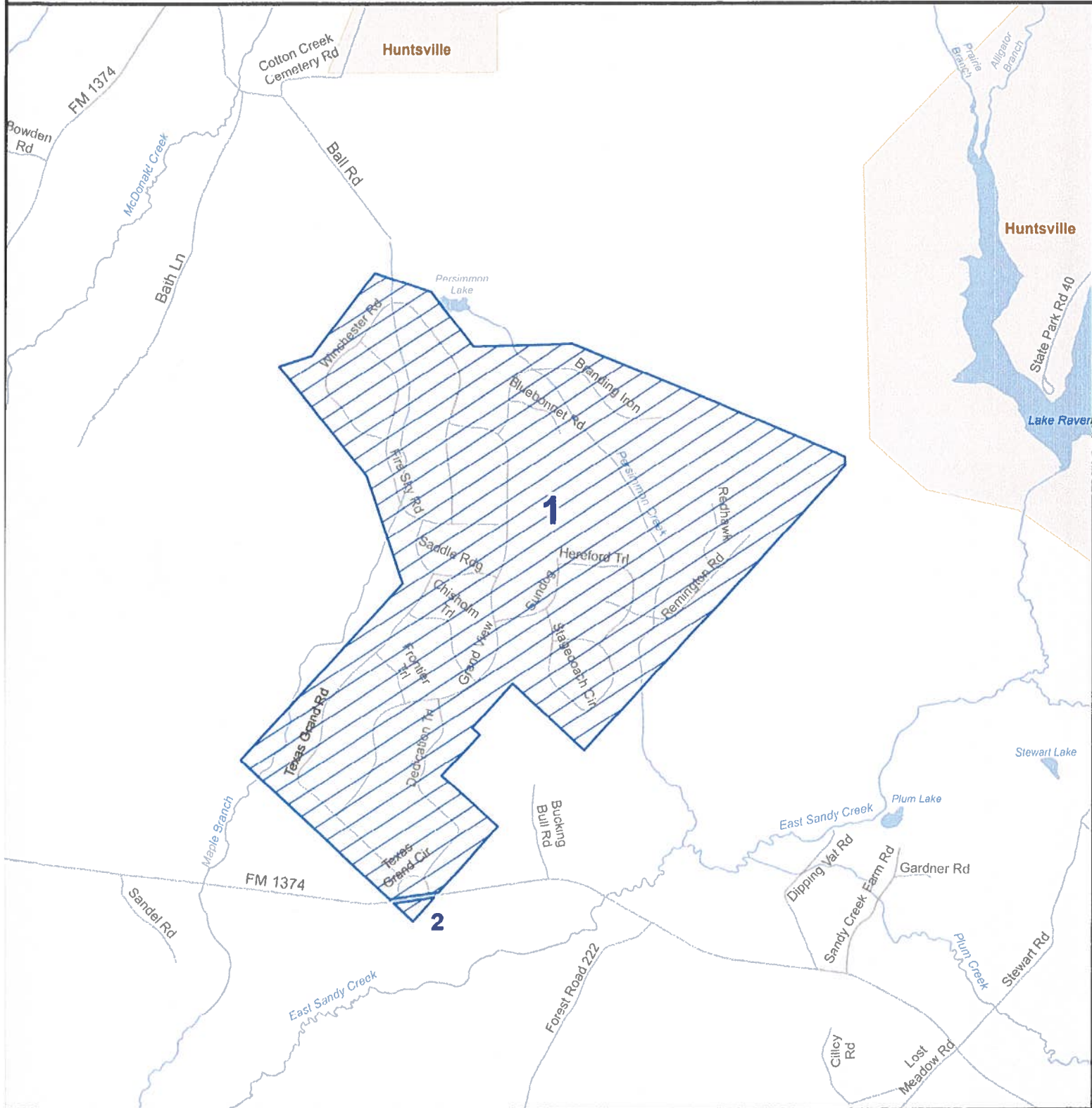

Detailed Map #1 - Texas Grand Ranch



Legend

 Requested Water Areas 1 and 2 to Transfer



Transfer Quadvest, L.P. (CCN No. 11612) to SJWTX, Inc. dba The Texas Water Company (CCN No. 10692) in Montgomery County

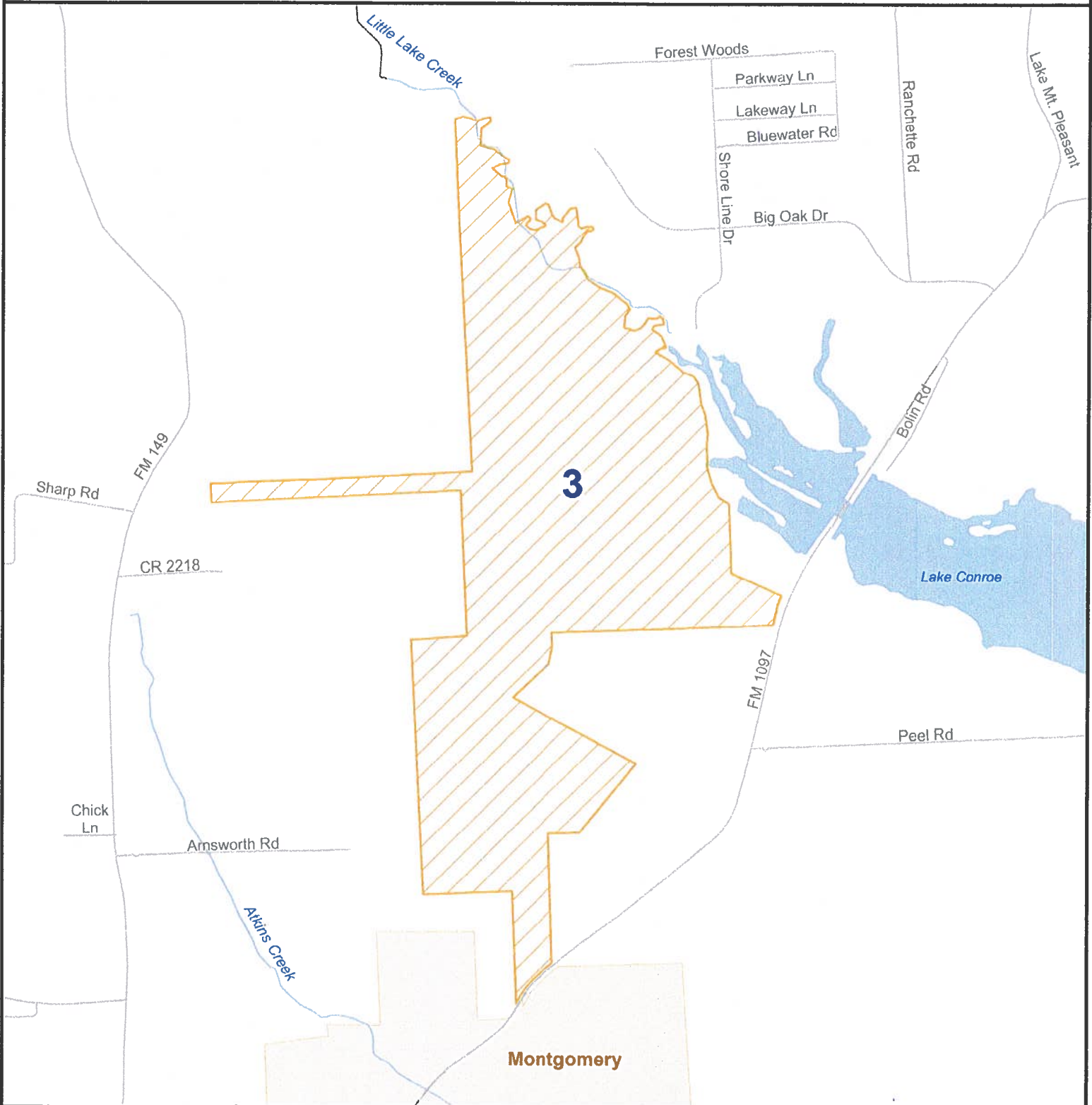

0 750 1,500
Feet

Detailed Map #2 - Firesong



Legend

 Requested Water Area 3 to Transfer

Transfer Quadvest, L.P. (CCN No. 11612) to SJWTX, Inc. dba The Texas Water Company (CCN No. 10692) in Montgomery County

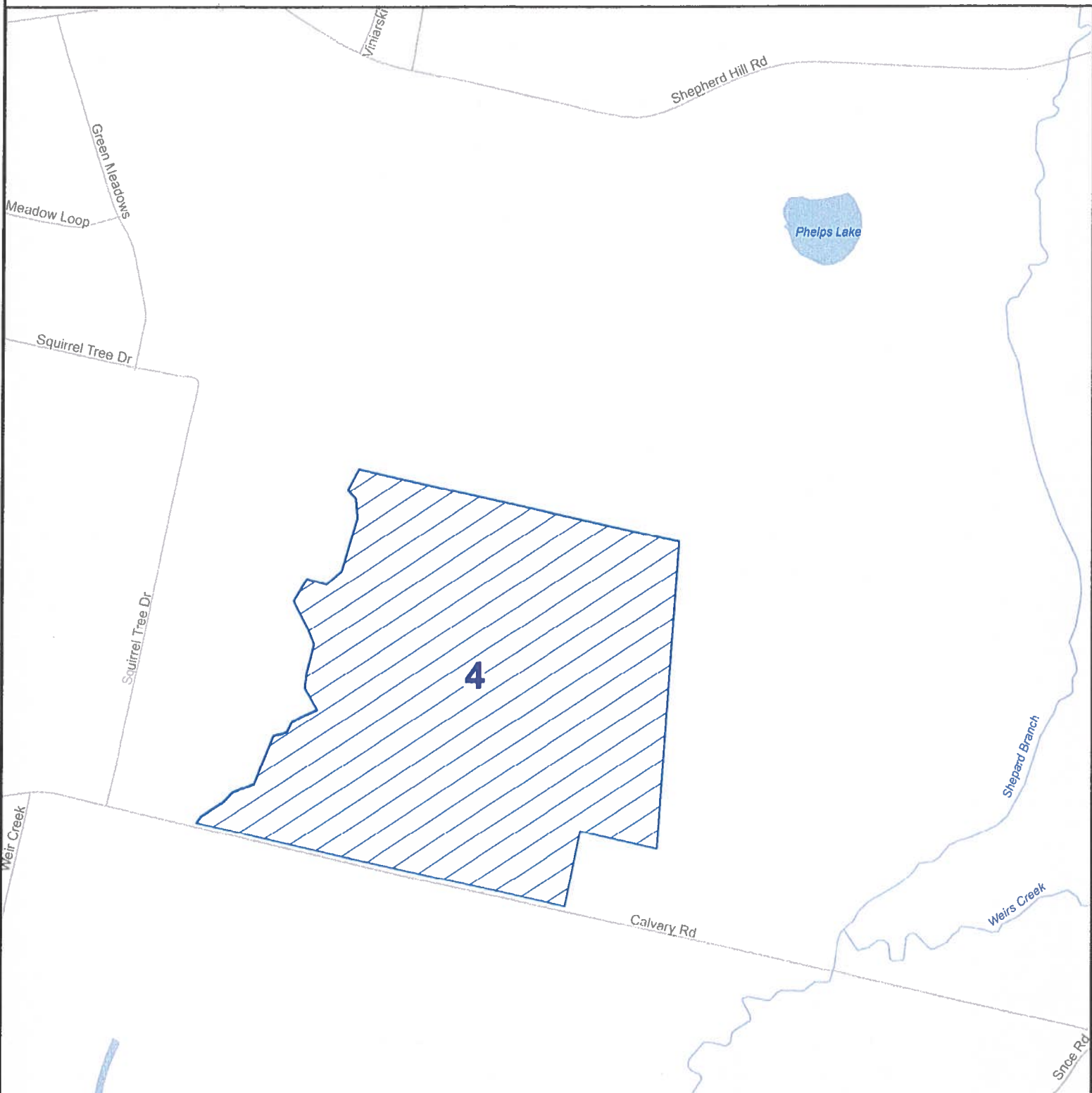

Detailed Map #3 - Rockrose Ranch



Legend

 Requested Water Area 4 to Transfer

Map by: Suzanne Burt
Date: January 13, 2026

Transfer Quadvest, L.P. (CCN No. 11612) to SJWTX, Inc. dba The Texas Water Company (CCN No. 10692) in Montgomery County

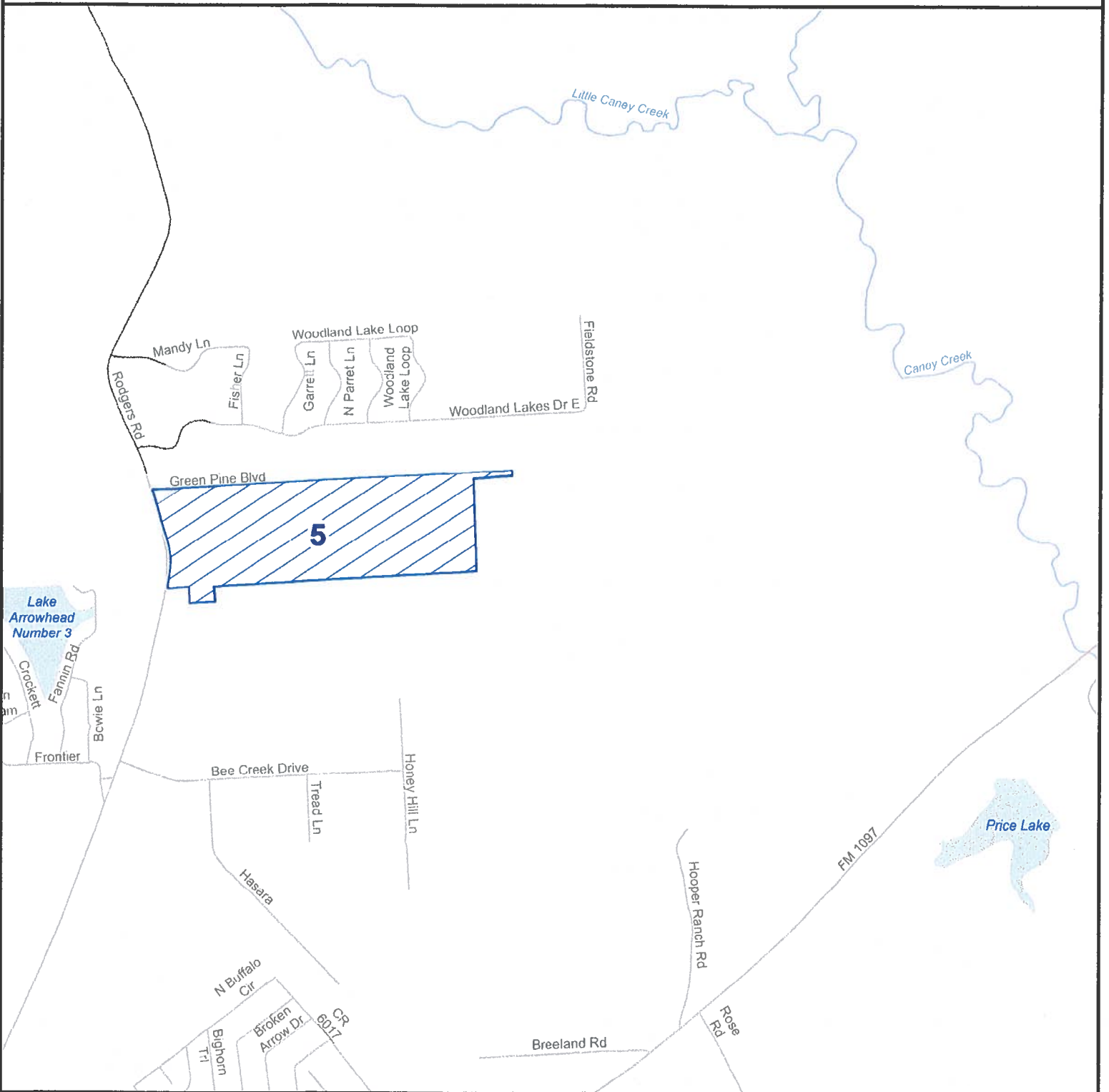

Detailed Map #4 - Undeveloped Area



Legend

 Requested Water Area 5 to Transfer



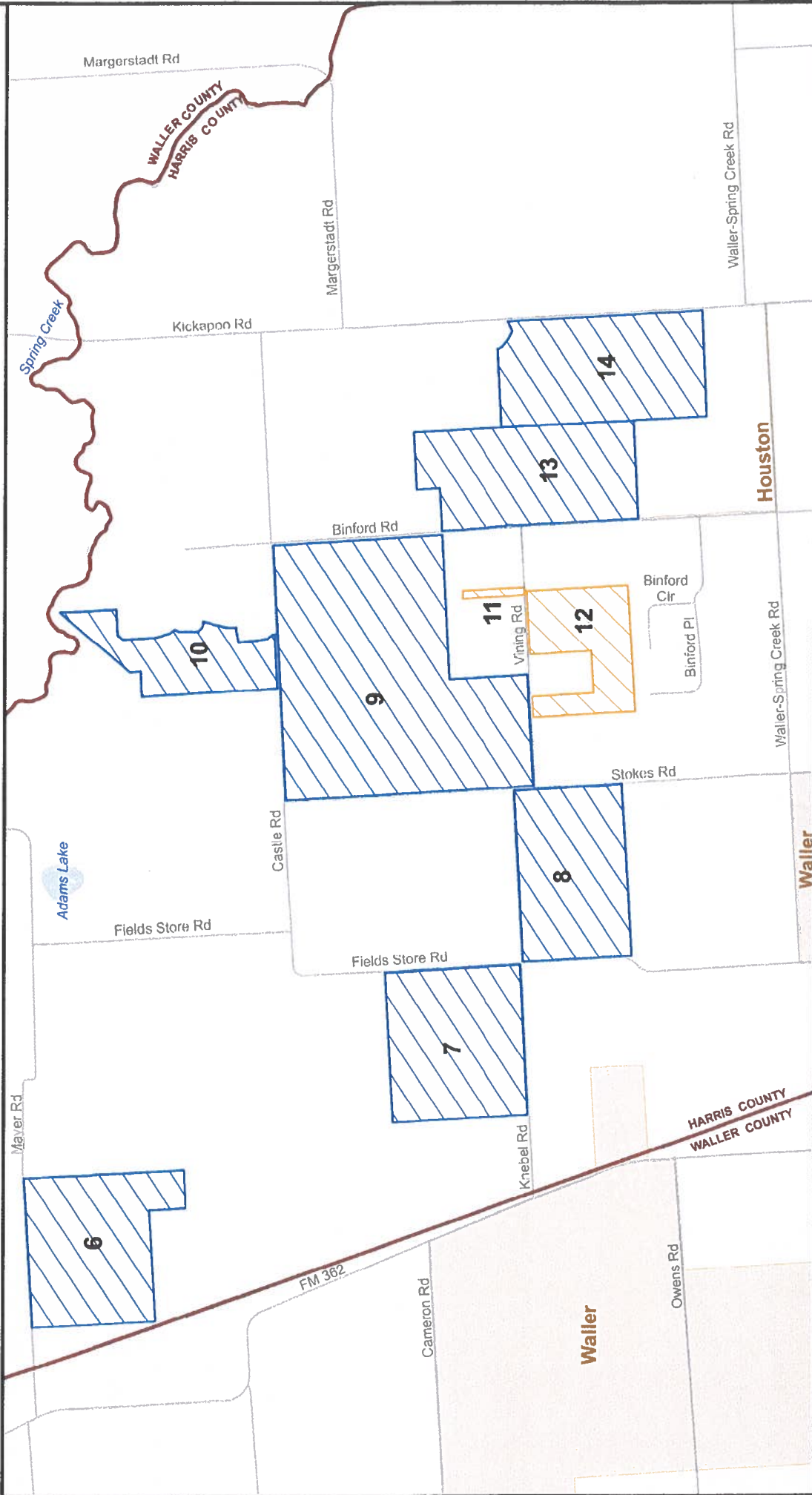

**Transfer Quadvest, L.P. (CCN No. 11612)
to SJWTX, Inc. dba The Texas Water Company (CCN No. 10692) in Harris County**



Detailed Map #5 - Westhaven Manor, Indigo Skies, Indigo Trails, Wild Rye, Stokesbury, BSR Vining Road, Binford Creek and Oakberry Trails

Legend

-  Requested Water Areas 6, 7, 8, 9, 10, 13, and 14 to Transfer
-  Requested Water Areas 11 and 12 to Transfer



Transfer Quadvest, L.P. (CCN No. 11612) to SJWTX, Inc. dba The Texas Water Company (CCN No. 10692) in Harris and Waller Counties

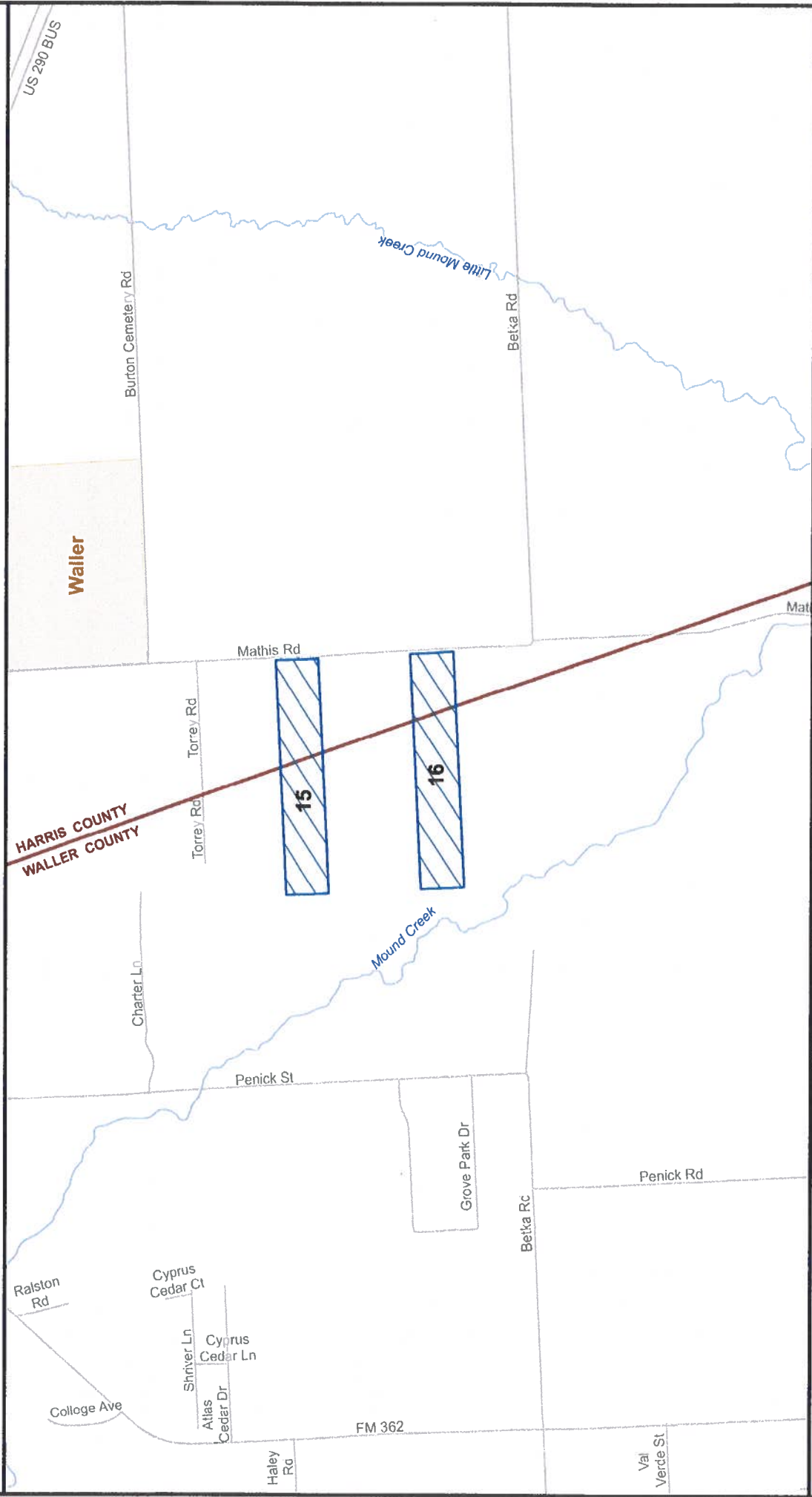

Detailed Map #6 - Mustang Meadows and Williams Landing



Legend

-  Requested Water Areas 15 and 16 to Transfer

Transfer Quadvest, L.P. (CCN No. 11612)
to SJWTX, Inc. dba The Texas Water Company (CCN No. 10692) in Waller County

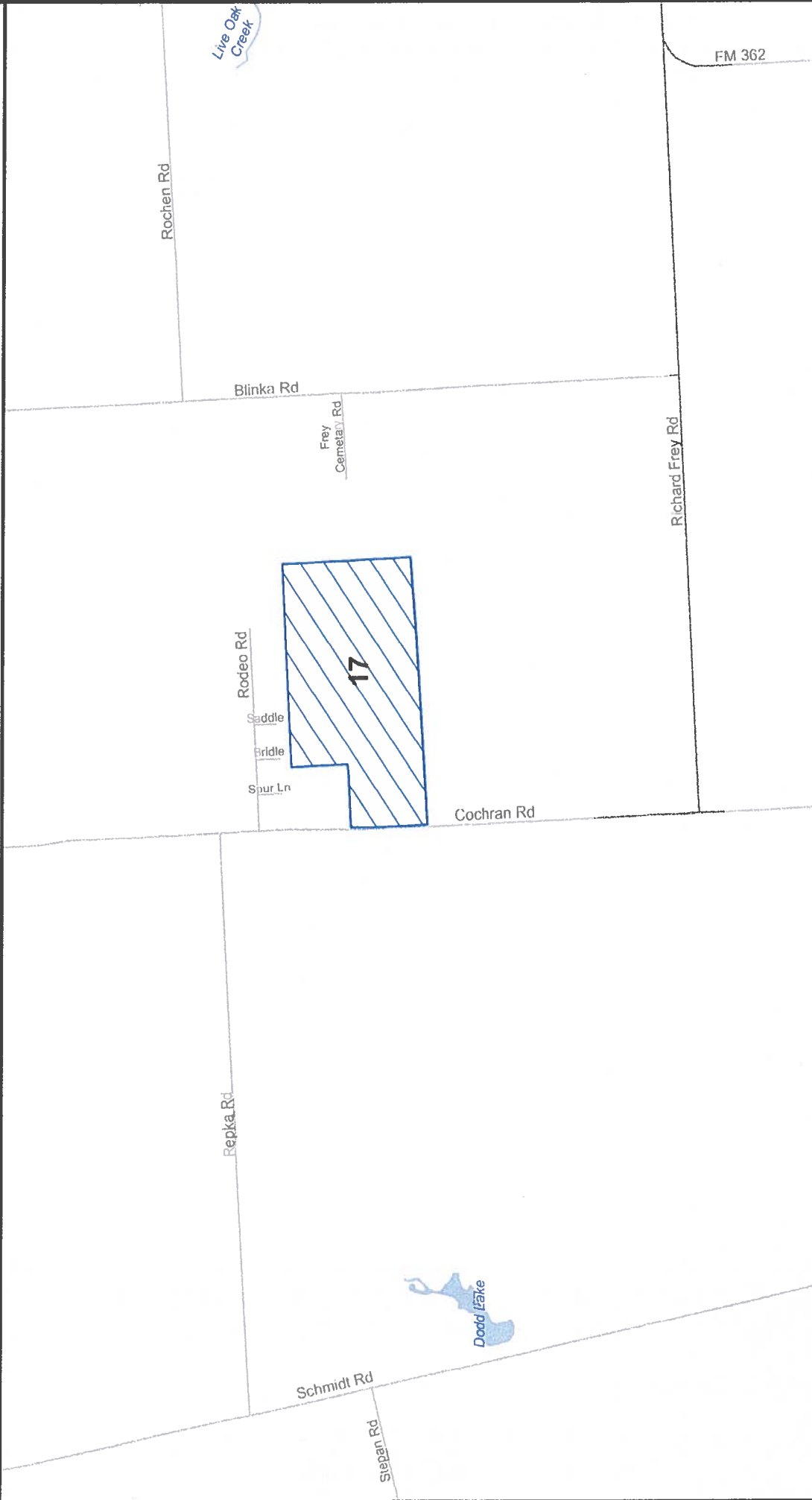

Detailed Map #7 - Trails at Cochran Ranch

Legend

 Requested Water Area 17 to Transfer



Transfer Quadvest, L.P. (CCN No. 11612) to SJWTX, Inc. dba The Texas Water Company (CCN No. 10692) in Montgomery and Waller Counties

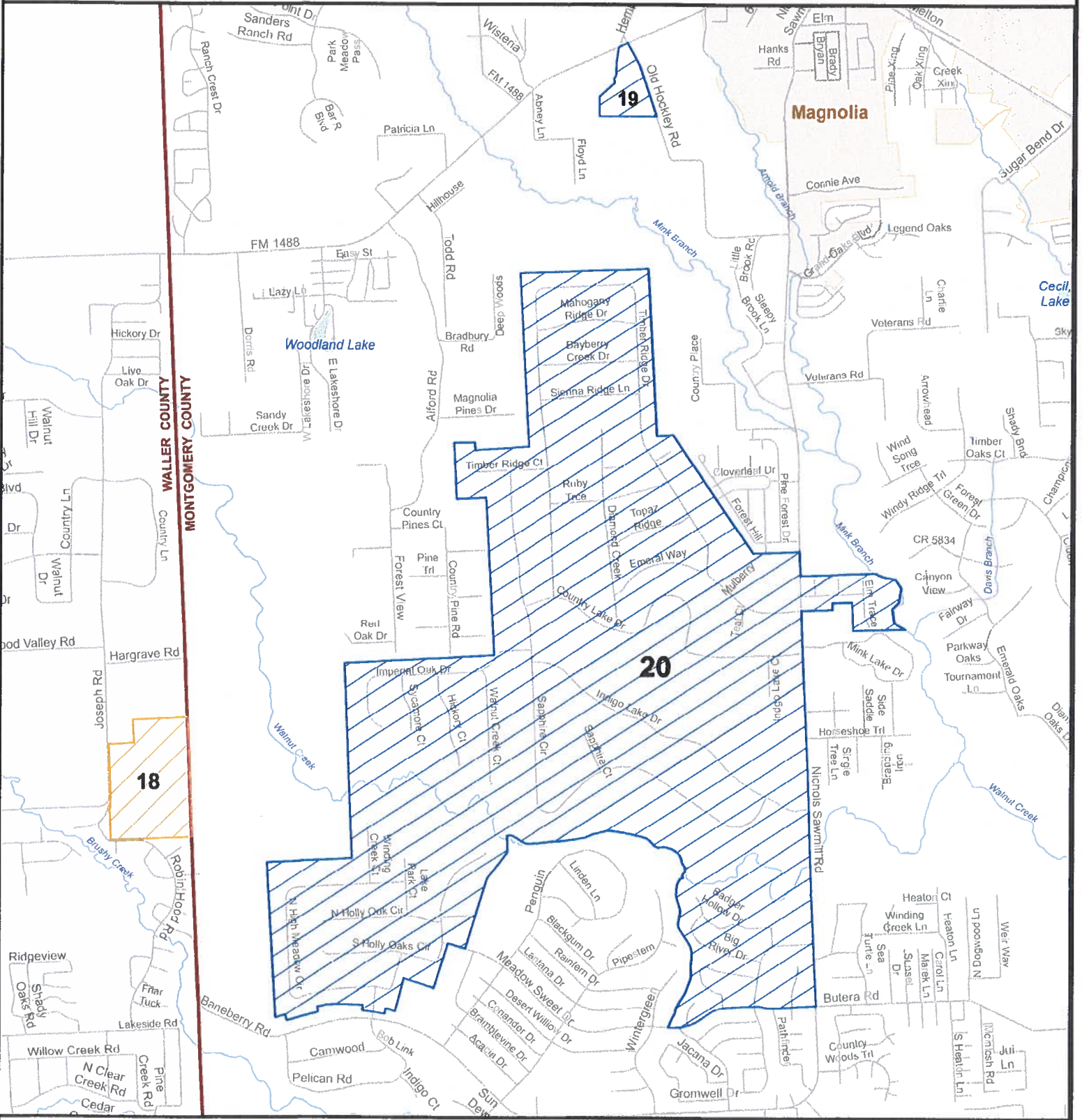

Detailed Map #8 - Maple Woods, Undeveloped Area, Indigo Lakes Estates, Estates of Clear Creek, Clear Creek Forest, and Sawmill Estates

0 1,750 3,500
Feet

Legend

-  Requested Water Areas 19 and 20 to Transfer
-  Requested Water Area 18 to Transfer



Map by: Suzanne Burt
Date: January 19, 2026

Transfer Quadvest, L.P. (CCN No. 11612) to SJWTX, Inc. dba The Texas Water Company (CCN No. 10692) in Montgomery County

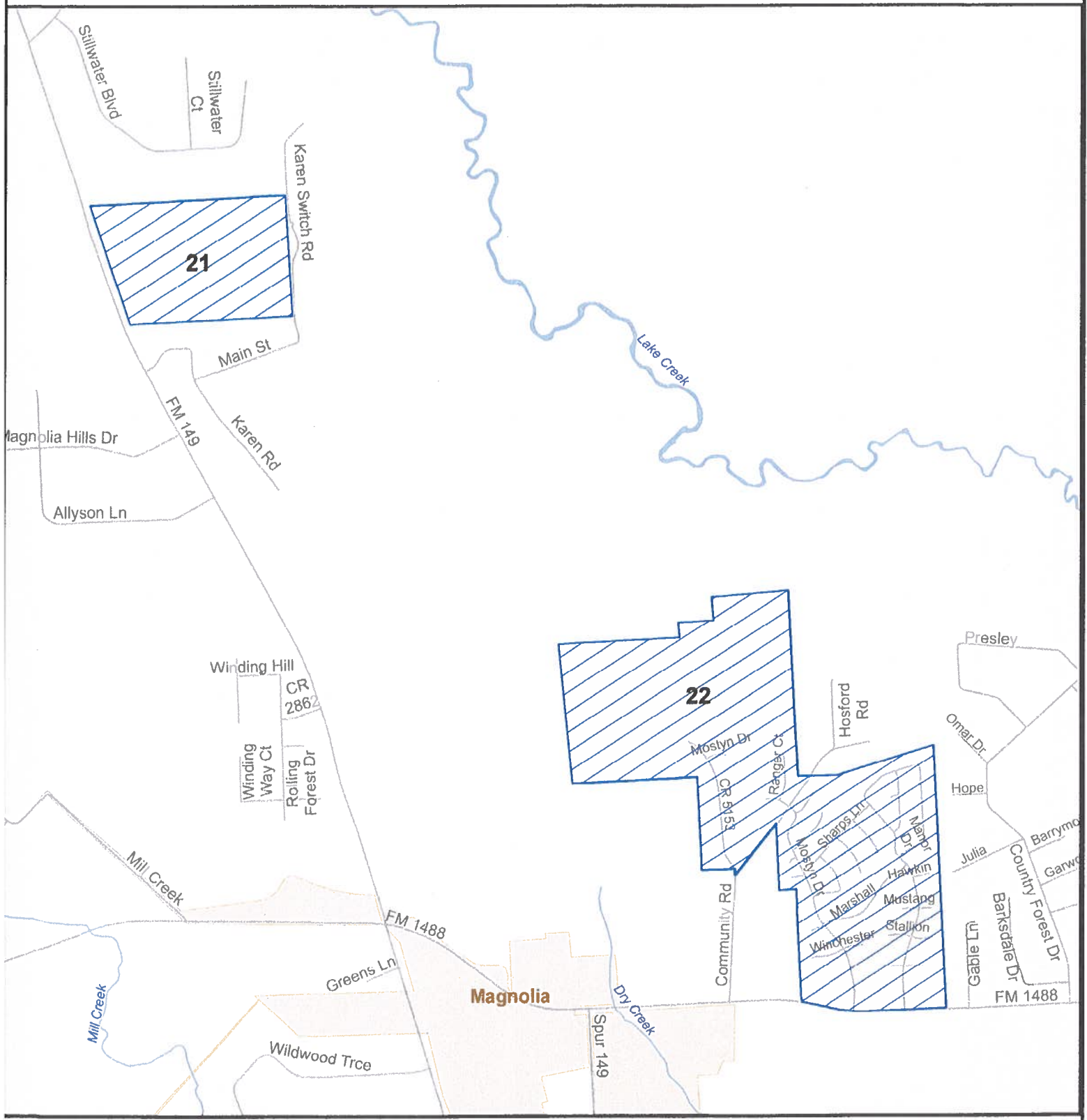

Detailed Map #9 - Magnolia Reserve, Mostyn Manor and Mostyn Springs



Legend

 Requested Water Areas 21 and 22 to Transfer



Map by: Suzanne Burt
Date: February 10, 2026

**Transfer Quadvest, L.P. (CCN No. 11612)
to SJWTX, Inc. dba The Texas Water Company (CCN No. 10692) in Montgomery County**

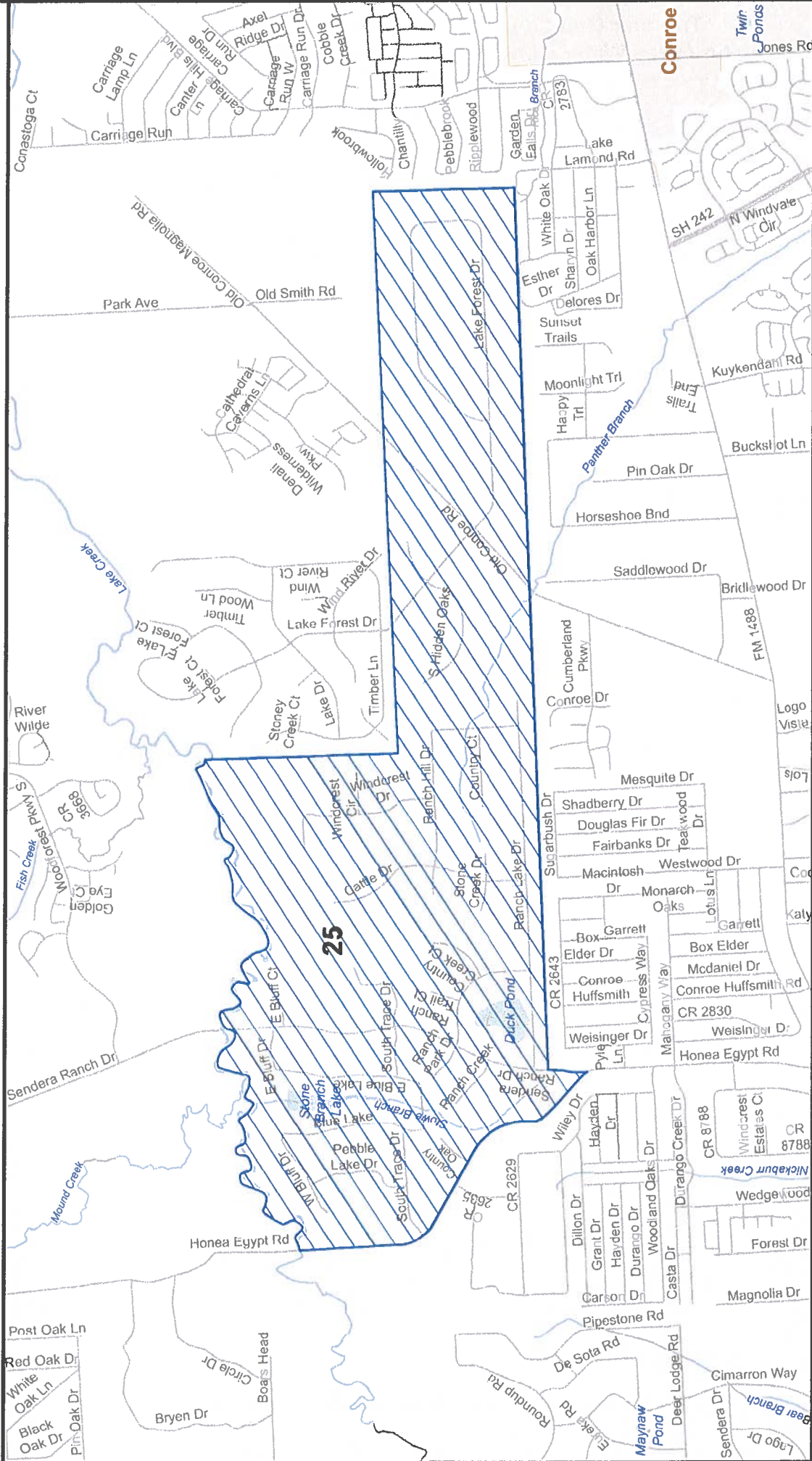

Detailed Map #11 - Montgomery Trace, Windcrest Farms, Sendera Ranch, Red Oak Ranch and Jacobs Reserve



Legend

 Requested Water Area 25 to Transfer

Transfer Quadvest, L.P. (CCN No. 11612) to SJWTX, Inc. dba The Texas Water Company (CCN No. 10692) in Montgomery County

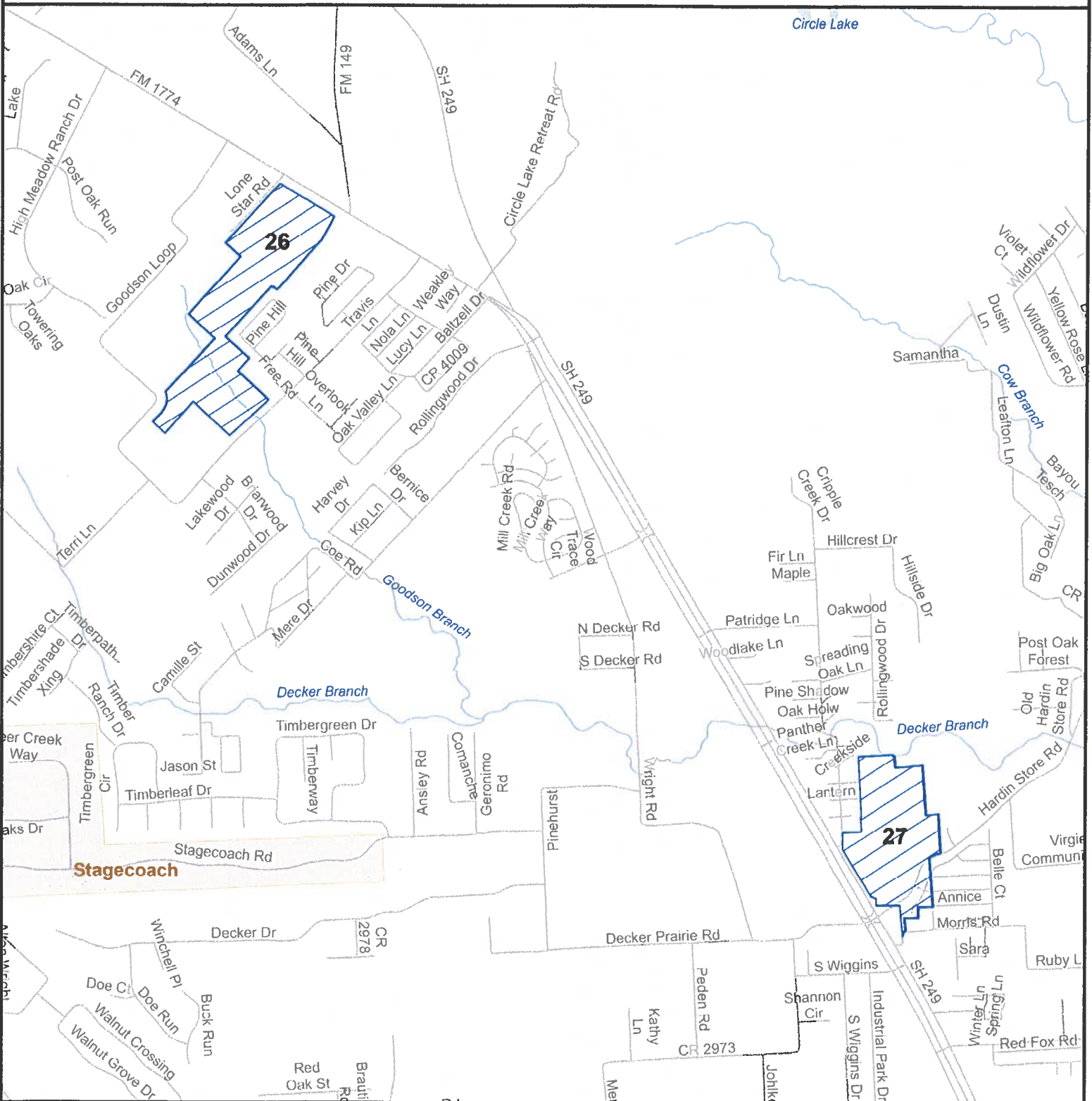

Detailed Map #12 - Colony at Pinehurst, Decker Oaks Estates and Village of Decker Oaks

0 1,250 2,500
Feet

Legend

 Requested Water Areas 26 and 27 to Transfer

Map by: Suzanne Burt
Date: February 10, 2026



Transfer Quadvest, L.P. (CCN No. 11612) to SJWTX, Inc. dba the Texas Water Company (CCN No. 10692) in Montgomery County

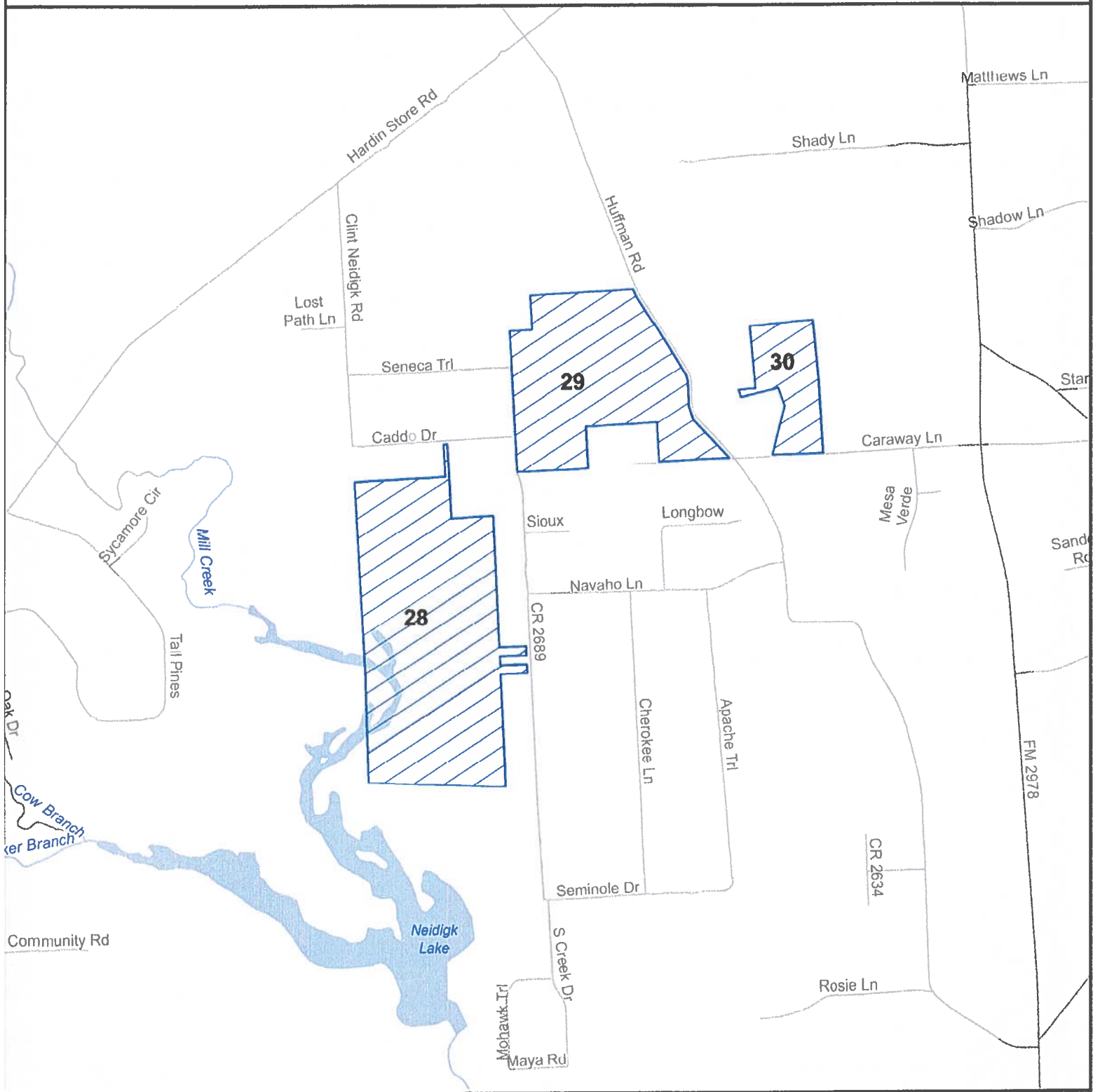

Detailed Map #13 - Mill Creek, Enclave at Dobbin and Creekside Court



Legend

 Requested Water Areas 28, 29 and 30 to Transfer



Transfer Quadvest, L.P. (CCN No. 20952) to SJWTX, Inc. dba The Texas Water Company (CCN No. 20877) in Liberty County

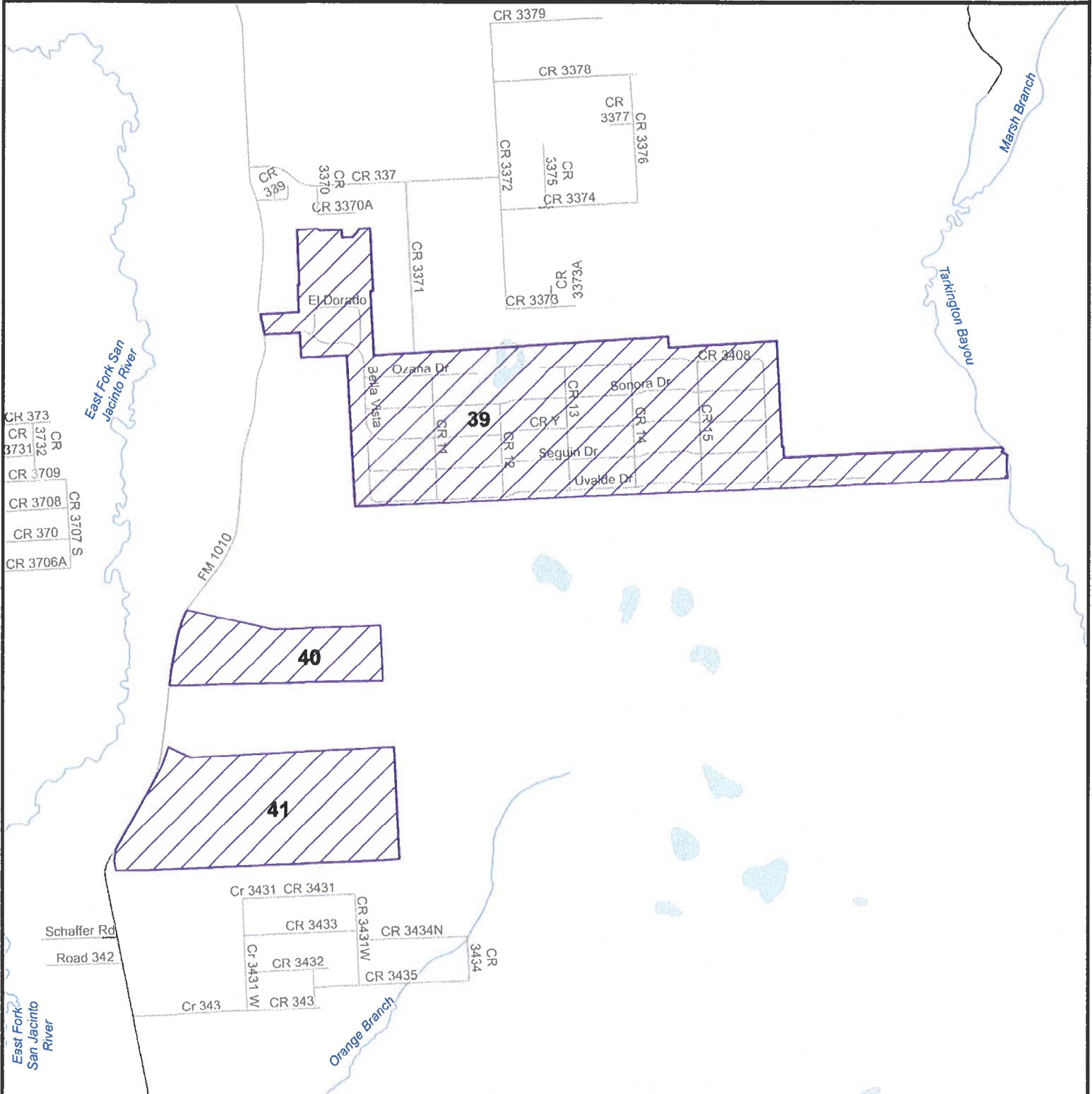

Detailed Map #19 - Royal Vista, Bella Vista, Villa Nueva and Rancho San Vicente



Legend

 Requested Sewer Areas 39, 40 and 41 to Transfer



Transfer Quadvest, L.P. (CCN No. 20952) to SJWTX, Inc. dba The Texas Water Company (CCN No. 20877) in Liberty and Montgomery Counties

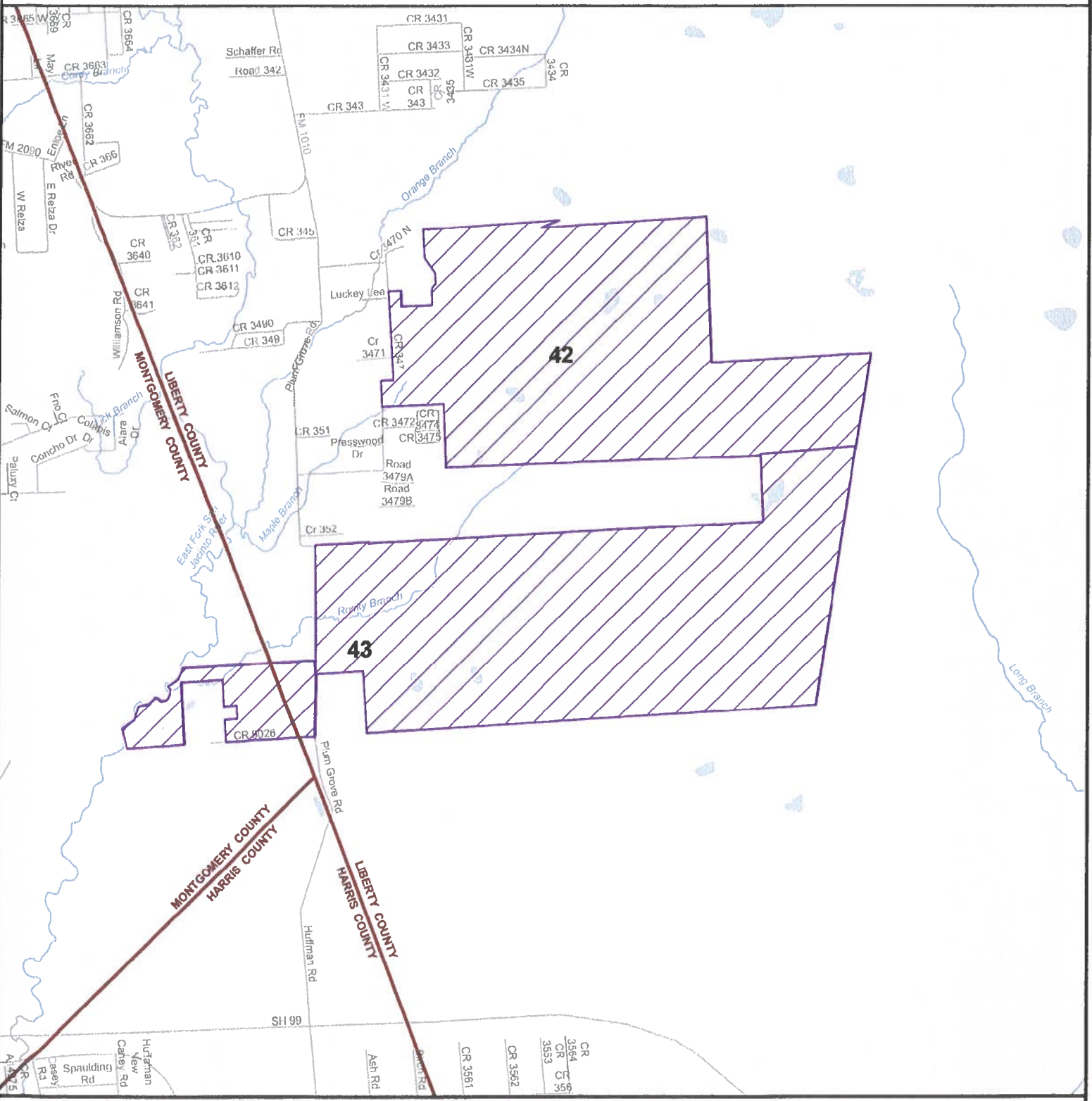

Detailed Map #20 - Camino Real and Grand San Jacinto



Legend

 Requested Sewer Areas 42 and 43 to Transfer



Map by: Suzanne Burt
Date: January 17, 2026

**Transfer Quadvest, L.P. (CCN No. 20952)
to SJWTX, Inc. dba The Texas Water Company (CCN No. 20877) in Harris and Waller Counties**

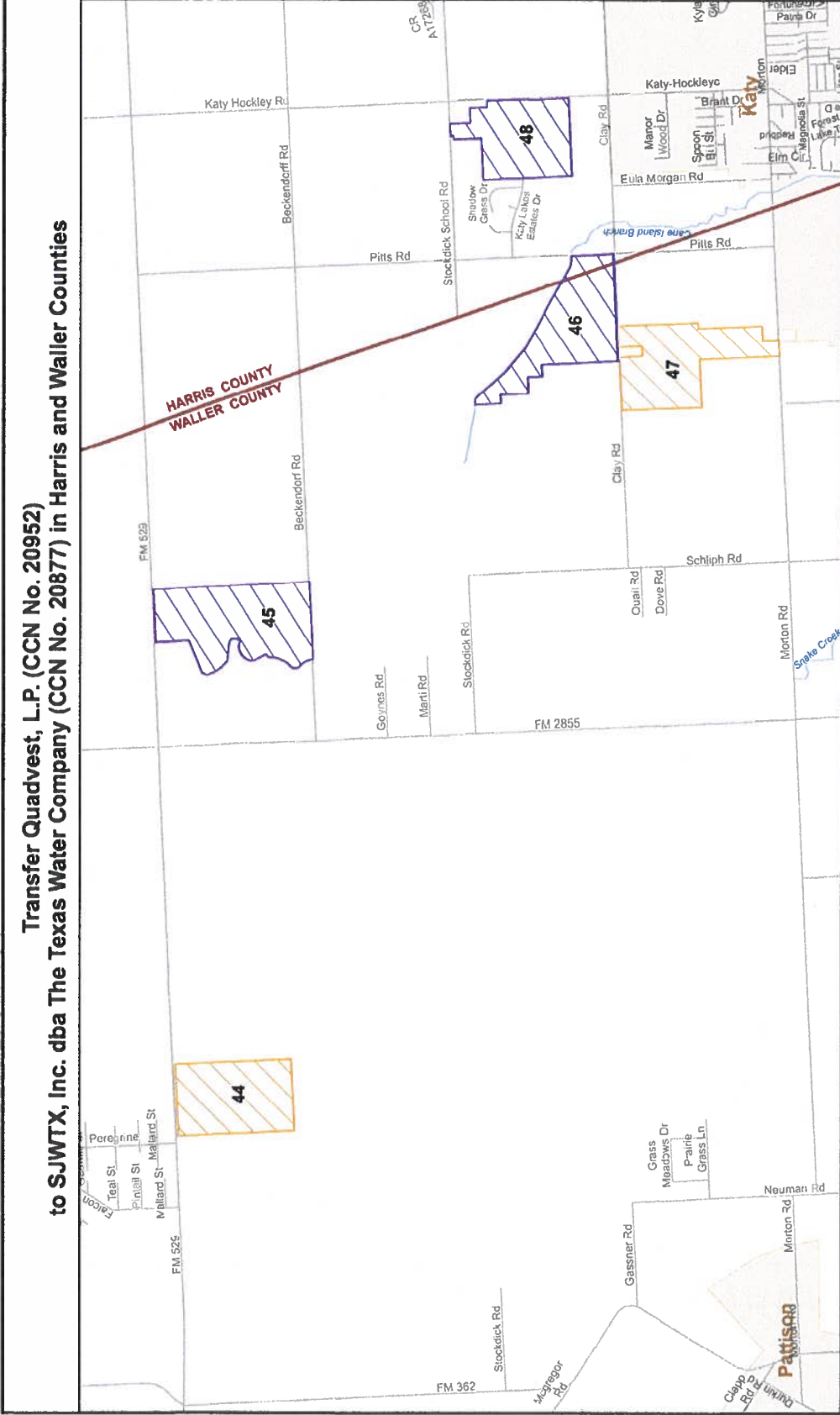

Detailed Map #21 - Dewberry Hills, Freeman Ranch, Lake House, Lakes of Cane Island, Reserve at Katy Hockley and Katy Meadows

Legend

-  Requested Sewer Areas 45, 46 and 48 to Transfer
-  Requested Sewer Areas 44 and 47 to Transfer



Map by: Suzanne Burt
Date: February 19, 2026

Transfer Quadvest, L.P. (CCN No. 20952) to SJWTX, Inc. dba The Texas Water Company (CCN No. 20877) in Fort Bend County

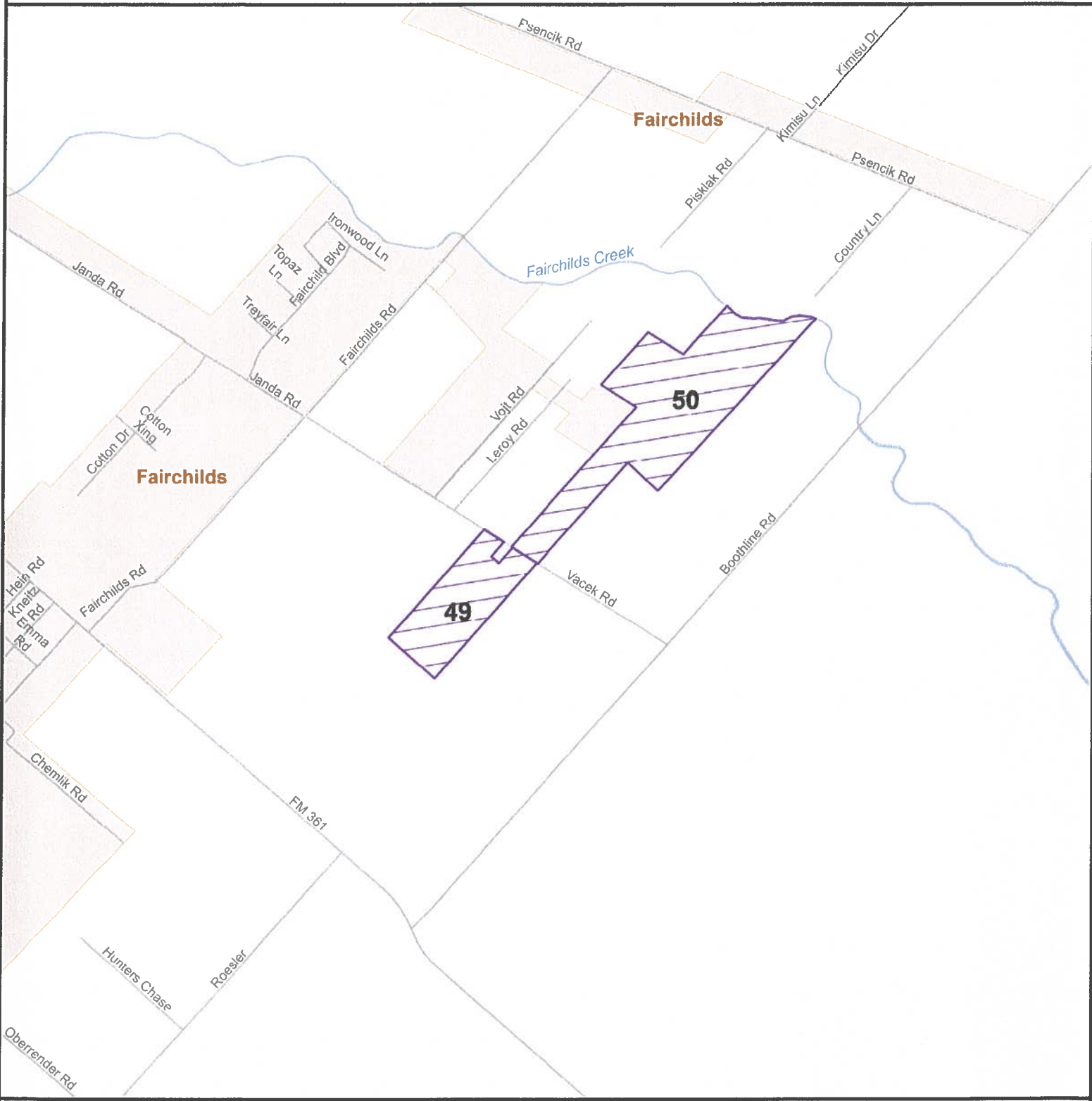

Detailed Map #22 - Vacek Pointe and Vacek Country Meadows



Legend

 Requested Sewer Areas 49 and 50 to Transfer



Map by: Suzanne Burt
Date: March 25, 2026

Transfer Quadvest, L.P. (CCN No. 20952) to SJWTX, Inc. dba The Texas Water Company (CCN No. 20877) in Fort Bend County



Detailed Map #23 - Olympia Falls



Legend

 Requested Sewer Area 51 to Transfer

Map by: Suzanne Burt
Date: January 17, 2026